



# THE NEWFOUNDLAND AND LABRADOR GAZETTE

## PART I

### PUBLISHED BY AUTHORITY

Vol. 86

ST. JOHN'S, FRIDAY, FEBRUARY 25, 2011

No. 8

#### MINERAL ACT

#### NOTICE

Published in accordance with section 62 of CNLR 1143/96 under the *Mineral Act*, cM-12, RSNL 1990 as amended.

Mineral rights to the following mineral lands have reverted to the Crown:

A portion of licence 15769M held by Ronald Sweetapple situate near Arnolds Cove, Eastern NL on map sheet 1N/13 more particularly described in an application on file at Department of Natural Resources

A portion of licence 12970M held by Benton Resource Corp. situate near Kingurutik Lake, 14D/16 more particularly described in an application on file at Department of Natural Resources

A portion of licence 13637M held by E. Michele Noel situate near Hickey's Pond, Burin Peninsula on map sheet 1M/16 more particularly described in an application on file at Department of Natural Resources

The lands covered by this notice except for the lands within Exempt Mineral Lands, the Exempt Mineral Lands being described in CNLR 1143/96 and NLR 71/98, 104/98, 97/00, 36/01, 31/04, 78/06, 8/08 and 28/09 and outlined on 1:50 000 scale digital maps maintained by the Department of Natural Resources, will be open for staking after the hour of 9:00 a.m. on the 32<sup>nd</sup> clear day after the date of this publication.

DEPARTMENT OF NATURAL RESOURCES  
JIM HINCHEY, P.Geol  
Manager - Mineral Rights

Feb 25

**CITY OF MOUNT PEARL ACT**



**NOTICE OF APPROVAL  
AMENDMENT TO ANIMAL CONTROL  
REGULATIONS**

TAKE NOTICE that the Mount Pearl City Council has amended sections 5 and 18 of the Animal Control Regulations. Section 5 covers the cost of annual licensing. Section 18 covers the cost of seizing and impounding fees both during and after regular hours.

These Regulations were amended by Council during the public council meeting of February 8<sup>th</sup>, 2011 and are available for viewing at City Hall. Any person who wishes may obtain a copy.

These regulations shall come into effect on March 1<sup>st</sup>, 2011.

CITY OF MOUNT PEARL  
Gerard Lewis, MMC, Chief Administrative Officer

P.O. # 56595

Feb 25

**URBAN AND RURAL PLANNING ACT**

**NOTICE OF REGISTRATION  
TOWN OF KIPPENS  
MUNICIPAL PLAN  
AMENDMENT NO. 7, 2010  
AND  
DEVELOPMENT REGULATIONS  
AMENDMENT NO. 9, 2010**

TAKE NOTICE that the TOWN OF KIPPENS Municipal Plan Amendment No. 7, 2010 and Development Regulations Amendment No. 9, 2010 as adopted on the 9<sup>th</sup> day of December, 2010 and approved on the 13<sup>th</sup> day of January, 2011, have been registered by the Minister of Municipal Affairs.

In general terms the purpose of the Municipal Plan amendment and Development Regulations amendment is to accommodate a residential subdivision off 361-367 Kippens Road and at the same time remove the line indicating the proposed highway between Kippens Road and St. George's Bay (Kippens Bypass) which affects this development – proposed Residential Designation and Zone (frontage to remain Mixed Development).

The Municipal Plan Amendment No. 7, 2010 and Development Regulations Amendment No. 9, 2010 come into effect on the day that this notice is published in *The Newfoundland and Labrador Gazette*.

Anyone who wishes to inspect a copy of the Kippens Municipal Plan Amendment No. 7, 2010 and Development Regulations Amendment No. 9, 2010 may do so at the Kippens Town Office during normal working hours.

TOWN OF KIPPENS  
Gerry Flynn, Town Clerk/CAO

Feb 25

**LANDS ACT**

**NOTICE OF INTENT  
*Lands Act c36, SNL 1999***

NOTICE is hereby given that HARRIET BURDETT-MOULTON of Yellowknife, NT intends to apply to the Department of Environment and Conservation, two months from the publication of this notice, to acquire title, pursuant to section 7(2) of the said Act, to that piece of Crown Land situated within fifteen (15) metres of the waters of Sandy Hill Cove, NL in the Electoral District of Cartwright-Lanse au Clair for the purpose of Residential more particularly described as follows:

*Bounded on the North by a River  
for a distance of 426.7 m;  
Bounded on the East by Marsh/Shrub Bush  
for a distance of 304.8 m;  
Bounded on the South by a Marsh  
for a distance of 457.2 ± m;  
Bounded on the West by Shrub/Bush  
for a distance of 243.815 ± m;  
and containing an area of  
approximately 130,058 square metres.*

Any person wishing to object to the application must file the objection in writing, within one month from the publication of this notice, with reasons for it, to the Minister of Environment and Conservation and mail to the nearest Regional Lands Office:

c/o Eastern Regional Lands Office, P.O. Box 8700, 5 Mews Place, St. John's, NL, A1B 4J6.

c/o Central Regional Lands Office, P.O. Box 2222, 230 Airport Boulevard, Fraser Mall, Gander, NL, A1V 2N9

c/o Western Regional Lands Office, P.O. Box 2006, 1 Riverside Drive, Noton Building, Corner Brook, NL, A2H 6J8

c/o Labrador Regional Lands Office, P.O. Box 3014, Station "B", Happy Valley-Goose Bay, NL, A0P 1E0  
For further information on the proposed application, please contact: HARRIET BURDETT-MOULTON at (867) 873-2740.

Feb 25

**MOTOR CARRIER ACT**

**PROVINCE OF  
NEWFOUNDLAND AND LABRADOR  
IN THE MATTER OF THE *MOTOR CARRIER ACT*,  
cM-19, RSNL 1990 AND  
IN THE MATTER OF THE APPLICATION FOR A  
MOTOR CARRIER CERTIFICATE**

**NOTICE OF APPLICATION**

TAKE NOTICE that Ferryland Emergency Services Ltd., P.O. Box 178, Ferryland, NL A0A 2H0 has applied to the Board of Commissioners of Public Utilities under the provisions of the *Motor Carrier Act*, cM-19, RSNL 1990, for the issuance of a Certificate as a motor carrier to provide the following service:

*IRREGULAR SPECIALITY AMBULANCE SERVICE  
for the transportation of persons  
requiring medical attention or under  
medical care upon the request of  
a Medical Doctor or Registered Nurse*

**from any point located on Highway Route No. 10 or accessed thereby, between and including Aquaforte and the southern boundary of La Manche Provincial Park and any point located on Highway Route No. 10, or accessed thereby, between and including Chance Cove Provincial Park and Aquaforte to any to any hospital, nursing home, first aid station or home for senior citizens and upon the specific request of a Medical Doctor, Registered Nurse or a Police Officer between any two points in Province of Newfoundland and Labrador.**

The Board, having reviewed the application, has granted provisional approval and shall issue said Certificate, unless a person who objects to the application files with the Board a notice of objection to the application together with a written statement setting out in full the reasons why the application should be denied and relevant documentary evidence. The objector must also serve on the applicant a copy of the notice of objection, the statement of reasons and the relevant documentary evidence filed with the Board by personal service or by prepaid, registered mail, at the address shown on the application, and proof of service must be supplied to the Board.

The evidence to be submitted must be received by the Board within twenty days of the date of the publication of this notice, at the office of the Board at Suite East 210, Prince Charles Building, Torbay Road, NL or by mail to P. O. Box 21040, St. John's, NL, A1A 5B2.

Dated at Ferryland this 15<sup>th</sup> day of February, 2011.

MARGARET CLOWE  
Applicant

Feb 25

**QUIETING OF TITLES ACT**

**2010 01G No: 6407  
IN THE SUPREME COURT OF  
NEWFOUNDLAND AND LABRADOR  
ST. JOHN'S (GENERAL DIVISION)**

IN THE MATTER OF the *Quieting of Titles Act*, RSNL, 1990, cQ-3 as amended;

AND IN THE MATTER OF an Application of STOS CONSULTING INC., a body corporate under the laws of the Province of Newfoundland and Labrador, pursuant to the said Act;

AND IN THE MATTER OF a piece or parcel of land situate and being on the western side of the Main Road to Calvert North in the Province of Newfoundland and Labrador

**NOTICE OF APPLICATION**

Notice of Application, under the *Quieting of Titles Act*, RSNL, 1990, cQ-3, as amended.

NOTICE IS HEREBY GIVEN to all parties that STOS CONSULTING INC. a body corporate under the laws of the Province of Newfoundland and Labrador, to have the lands situate at Calvert, being more particularly described in the metes and bounds descriptions annexed hereto as Schedule "A" respectively to be investigated and for a declaration that STOS CONSULTING INC. is the absolute owner in fee simple of the said lands.

All persons having title adverse to the title claimed by the STOS CONSULTING INC shall file in the Registry of the Supreme Court of Newfoundland and Labrador, St. John's, in the Province of Newfoundland and Labrador, particulars of such adverse claim and serve the same on the undersigned solicitors for the Applicant on or before the 1<sup>st</sup> day of April, 2011 after which date no party having any claim shall be permitted to file the same or to be heard except by special leave of the Court and subject to such conditions as the Court may deem just.

DATED at St. John's, in the Province of Newfoundland and Labrador on this 28<sup>th</sup> day of January, 2011

O'BRIEN & ANTHONY  
Solicitors for the Applicant  
PER: Gerald F. O'Brien, Q.C.

ADDRESS FOR SERVICE  
279 Duckworth Street  
St. John's, NL A1C 1G9  
Tel: (709) 722-0637  
Fax: (709) 722-6780

**SCHEDULE “A”**

Description  
Main Road, Calvert

All that piece or parcel of land situate and being west of the Main Road in Calvert, in the Electoral District of Ferryland, in the Province of Newfoundland and Labrador, Canada, abutted and bounded as follows, that is to say: Beginning at a point the said point having M.T.M. Grid Coordinates of north 5 213 044.486 metres and east 311 435.783 metres,

THENCE running by land of Alexander Ryan, south fifty five degrees fifty-nine minutes fifty-five seconds west, forty-eight decimal six five zero metres,

THENCE running by land of Alexander Ryan, south twenty-nine degrees fifteen minutes twelve seconds west, twenty-three decimal two eight seven metres.

THENCE running by Crown Land, north eighty-seven degrees forty-five minutes forty one seconds west, one hundred and forty-one decimal seven one two metres,

THENCE running by Crown Land, north sixty-six degrees seventeen minutes twenty-four seconds west, three hundred and sixty-seven decimal eight two zero metres,

THENCE running by Crown Land, north ten degrees fifty-eight minutes thirty seconds east, one hundred and ninety-five decimal six six two metres,

THENCE running by a ten metre Reservation on Calvert River, south seventy-seven degrees eleven minutes thirty seconds east, fifty decimal two seven seven metres,

THENCE running by a ten metre Reservation on Calvert River, north eighty-seven degrees forty-eight minutes fifty seconds east, fifty-five decimal zero zero six metres,

THENCE running by a ten metre Reservation on Calvert River, south seventy-six degrees fifty-six minutes ten seconds east, eighty decimal five two five metres,

THENCE running by the waters of Gut Pond, south twenty-one degrees eighteen minutes zero one seconds east, thirty-nine decimal eight eight five metres,

THENCE running by the waters of Gut Pond, south forty-six degrees seventeen minutes fifty-nine seconds east, forty-three decimal two five eight metres,

THENCE running by the waters of Gut Pond, south eighty-one degrees twenty-five minutes thirty-six seconds east, seventy-eight decimal zero nine three metres,

THENCE running by the waters of Gut Pond, south sixty-six degrees zero seven minutes nineteen seconds east, fifteen decimal seven four zero metres,

THENCE running by the waters of Gut Pond, south forty-two degrees forty-five minutes forty-two seconds east, seventeen decimal four one nine metres,

THENCE running by the waters of Gut Pond, south eighty-seven degrees zero five minute fifty-eight seconds west, twenty-one decimal three six zero metres,

THENCE running by the waters of Gut Pond, south six degrees thirty-five minutes twenty-five seconds west, five decimal zero eight four metres,

THENCE running by the waters of Gut Pond, south thirty-three degrees forty-one minutes fifty-nine seconds east, six decimal nine eight one metres,

THENCE running by the Halley Estates, south twenty-three degrees zero seven minutes zero five seconds east, thirteen decimal two one one metres,

THENCE running by the Halley Estates, south thirty degrees fifty-nine minutes twenty-six seconds east, forty-four decimal three zero nine metres,

THENCE running by the Halley Estates, south zero degrees thirty-six minutes ten seconds west, eighteen decimal one five seven metres,

THENCE running by the Halley Estates, south thirteen degrees thirty-three minutes twenty-seven seconds west, twenty-four decimal two two four metres,

THENCE running by the Halley Estates, south eleven degrees fifty-one minutes forty-eight seconds east, eighteen decimal one four six metres,

THENCE running by the Halley Estates, south fifty-four degrees thirty-nine minutes zero two seconds east, sixteen decimal zero eight four metres,

THENCE running by the Halley Estates, south seventy-seven degrees zero zero minutes forty seconds east, twenty-one decimal six eight two metres,

THENCE running by the Halley Estates, south sixty-nine degrees nineteen minutes fifty-six seconds east, ninety-four decimal four one three metres,

THENCE running by the Halley Estates, south eighty-two degrees fifty-one minutes zero three seconds east, thirty-one decimal zero four one metres, more or less to the point of beginning and containing in all an area of 9.0486 hectares, more or less which land is more particularly shown on the plan hereto attached.

All bearings are referred to Grid North NAD-83.

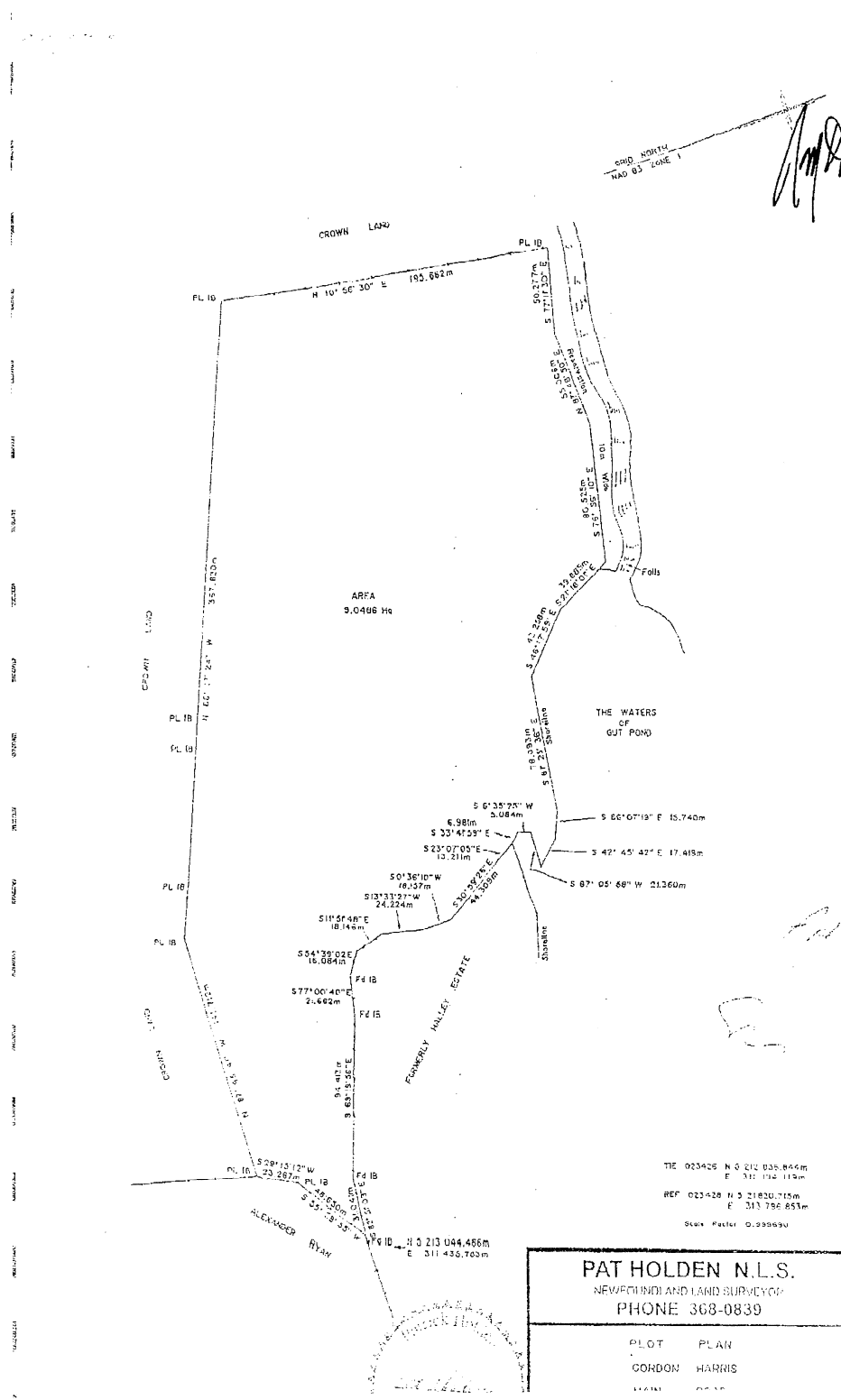

**2010 01G 6408**  
**IN THE SUPREME COURT OF**  
**NEWFOUNDLAND AND LABRADOR**  
**ST. JOHN'S (GENERAL DIVISION)**

**SCHEDULE "A"**

NOTICE OF APPLICATION under the *Quieting of Titles Act*, RSNL, cQ-3

AND IN THE MATTER OF an Application of STOS CONSULTING INC. a body corporate under the laws of the Province of Newfoundland and Labrador, pursuant to the said Act;

AND IN THE MATTER OF a piece or parcel of land situate and being on the western side of the Main Road to Calvert North in the Province of Newfoundland and Labrador

**NOTICE OF APPLICATION**

Notice of Application, under the *Quieting of Titles Act*, RSNL, 1990, cQ-3, as amended.

NOTICE IS HEREBY GIVEN to all parties that STOS CONSULTING INC. a body corporate under the laws of the Province of Newfoundland and Labrador, to have the lands situate at Calvert, being more particularly described in the metes and bounds descriptions annexed hereto as Schedule "A" respectively to be investigated and for a declaration that STOS CONSULTING INC. is the absolute owner in fee simple of the said lands.

All persons having title adverse to the title claimed by the STOS CONSULTING INC shall file in the Registry of the Supreme Court of Newfoundland and Labrador, St. John's, in the Province of Newfoundland and Labrador, particulars of such adverse claim and serve the same on the undersigned solicitors for the Applicant on or before the 1<sup>st</sup> day of April, 2011 after which date no party having any claim shall be permitted to file the same or to be heard except by special leave of the Court and subject to such conditions as the Court may deem just.

DATED at St. John's, in the Province of Newfoundland and Labrador on this 28<sup>th</sup> day of January, 2011

O'BRIEN & ANTHONY  
Solicitors for the Applicant  
PER: Gerald F. O'Brien, Q.C.

ADDRESS FOR SERVICE  
279 Duckworth Street  
St. John's, NL A1C 1G9  
Tel: (709) 722-0637  
Fax: (709) 722-6780

Description  
Main Road, Calvert

All that piece or parcel of land situate and being west of the Main Road in Calvert, in the Electoral District of Ferryland, in the Province of Newfoundland and Labrador, Canada, abutted and bounded as follows, that is to say: Beginning at a point the said point having M.T.M. Grid Coordinates of north 5 213 047.412 metres and east 311 511.500 metres,

THENCE running by land of Alexander Ryan, north eighty-eight degrees forty-six minutes twenty-five seconds west, five decimal one nine nine metres,

THENCE running by land of Alexander Ryan, south eighty-six degrees fifty-three minutes fifty seconds west, fifty-four decimal eight one five metres,

THENCE running by land of Alexander Ryan, south eighty-nine degrees forty-four minutes thirty-six seconds west, fifteen decimal seven eight five metres,

THENCE running by land of Michael Johnson, north eighty-two degrees fifty-one minutes zero three seconds west, thirty-one decimal zero four one metres,

THENCE running by land of Michael Johnson, north sixty-nine degrees nineteen minutes fifty-six seconds west, ninety-four decimal four one three metres,

THENCE running by land of Michael Johnson, north seventy-seven degrees zero zero minutes forty seconds west, twenty-one decimal six eight two metres,

THENCE running by land of Michael Johnson, north fifty-four degrees thirty-nine minutes zero two seconds west, sixteen decimal zero eight three metres,

THENCE running by land of Michael Johnson, north eleven degrees fifty-one minutes forty-eight seconds west, eighteen decimal one four six metres,

THENCE running by land of Michael Johnson, north thirteen degrees thirty-three minutes twenty-seven seconds east, twenty-four decimal two two four metres,

THENCE running by land of Michael Johnson, north zero degrees thirty-six minutes ten seconds east, eighteen decimal one five seven metres,

THENCE running by land of Michael Johnson, north thirty degrees fifty-nine minutes twenty-six seconds west, forty-four decimal three zero nine metres,

THENCE running by land of Michael Johnson, north twenty-three degrees zero seven minutes zero five seconds west, thirteen decimal two one one metres,

THENCE running by the waters of Gut Pond, south eighty-nine degrees thirty-two minutes fifty-three seconds east, thirty decimal seven zero eight metres,

THENCE running by the waters of Gut Pond, north eighty-seven degrees fifteen minutes twenty-one seconds east, seven decimal zero four three metres,

THENCE running by the waters of Gut Pond, south eighty-seven degrees twenty-four minutes nineteen seconds east, thirteen decimal two eight nine metres,

THENCE running by the waters of Gut Pond, south eighty-seven degrees thirty-nine minutes twenty-nine seconds east, fifteen decimal nine eight zero metres,

THENCE running by the waters of Gut Pond, south fifty-nine degrees fifty-eight minutes thirteen seconds east, thirty-seven decimal two three eight metres,

THENCE running by land of Her Majesty The Queen in Right of Canada, south thirty-five degrees twenty-five minutes thirty-eight seconds west, thirty-four decimal nine five zero metres,

THENCE running by land of Her Majesty The Queen in Right of Canada, south fifty-five degrees zero five minutes zero five seconds east, thirty-eight decimal seven five zero metres,

THENCE running by land of Her Majesty The Queen in Right of Canada, north thirty-five degrees forth-six minutes thirty-eight seconds east, thirty-eight decimal four six one metres,

THENCE running by a Public Right of way, south seventy-one degrees eighteen minutes fifteen seconds east, six decimal six nine zero metres,

THENCE running by a Public Right of way, south sixty degrees fifty-one minutes sixteen seconds east, twenty-seven decimal seven three nine metres,

THENCE running by a Public Right of way, south seventy-one degrees forty-five minutes twenty-four seconds east, thirty-five decimal seven five zero metres,

THENCE running by the Main Road, 64.922 metres along the arc of a curve of radius 351.761 metres, whose bearing and chord distance is south fifteen degrees zero four minutes forty-five seconds west, sixty-four decimal eight two nine metres, more or less to the point of beginning and containing in all an area of 24138.24 square metres, more or less which land is more particularly shown on the plan hereto attached.

All bearings are referred to Grid North NAD-83.

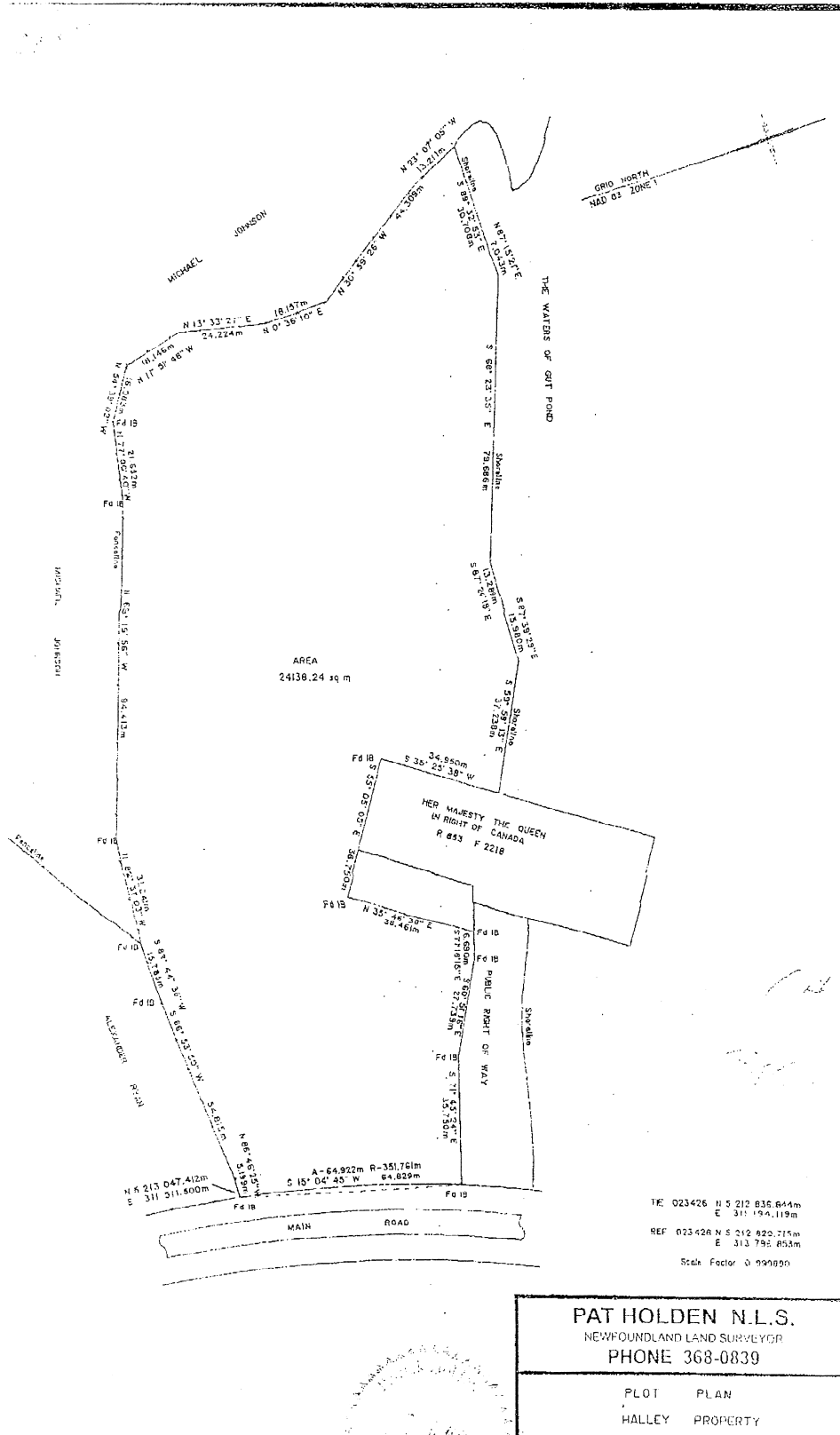

Feb 18 & 25



**TRUSTEE ACT**

**ESTATE NOTICE**

IN THE MATTER OF the Estate of PATRICK WALTER CRANE late of the City of St. John's in the Province of Newfoundland and Labrador, deceased.

All persons claiming to be creditors of or who have any claims or demands upon or affecting the Estate of PATRICK WALTER CRANE aforesaid, deceased, who died at St. John's in the Province of Newfoundland and Labrador, on or about the 14<sup>th</sup> day of December, 2010, are hereby requested to send particulars thereof in writing, duly attested, to the undersigned Solicitor for the Executor of the Estate of the said deceased on or before the 18<sup>th</sup> day of March, 2011, after which date the Executor will proceed to distribute the Estate having regard only to the claims of which it shall then have had notice.

DATED at St. John's, Newfoundland and Labrador, this 18<sup>th</sup> day of February, 2011.

BENSON MYLES PLC INC.  
Solicitor for the Executor  
PER: J. David B. Baird, QC

**ADDRESS FOR SERVICE**

Suite 900, Atlantic Place  
P.O. Box 1538  
Water Street  
St. John's, NL A1C 5N8  
Tel: (709) 579-2081  
Fax: (709) 579-2647

Feb 25

---

**ESTATE NOTICE**

IN THE MATTER OF the Estate and Effects of late MARGARET DIANE HUMPHRIES of the Town of Gander, in the Province of Newfoundland and Labrador, Homecare Provider, Deceased.

All persons claiming to be creditors of or who have any claims or demands upon or affecting the Estate of MARGARET DIANE HUMPHRIES, the aforesaid deceased, who died at the Town of Gander, in the Province of Newfoundland and Labrador on or about the 21<sup>st</sup> day of October, 2010, are hereby requested to send particulars thereof in writing, duly attested, to the undersigned Solicitor for the Administrator of the Estate on or before the 3<sup>rd</sup> day of March, 2011, after which date the Administrator will proceed to distribute the said Estate having regard only to the claims of which he shall then have had notice.

DATED at the Town of Gander, Newfoundland and Labrador, this 14<sup>th</sup> day of February, 2011.

BONNELL LAW  
Solicitor for the Administrator  
PER: R. Archibald Bonnell

**ADDRESS FOR SERVICE:**

P.O. Box 563  
218 Airport Boulevard  
Gander, NL A1V 2E1  
Tel: (709) 651-4949  
Fax: (709) 651-4951

Feb 25 & Mar 4

---

CHANGE OF NAME ACT, 2009

Legal Name Changes  
Processed During the Period  
JANUARY 2010

<u>Former Name</u>	<u>Present Name</u>	<u>ADDRESS</u>
Taylor, Mia Madeline	Taylor-Curnew, Mia Madeline	Brigus
Clowe, Nicole Margaret	Clowe-Paul, Nicole Margaret	Ferryland
Agadzanyan, Tamara	Mamedova, Tamara	St. John's
Molloy-Nemec, Kelsey Wanda	Molloy, Kelsey Wanda	Torbay
Martin, Lincoln Michael	Druken-Martin, Lincoln Michael	Goulds
Jajoo, Pinki Ramnarayan	Kumar, Pinki	St. John's
Skinner, Cameron Tyler	Skinner-Jesso, Cameron Tyler	Port au Port
Humber, Dawson Jack	Humber-Carter, Dawson Jack	Corner Brook
Patey, Stelison Taylor	Taylor, Stelison	Peterview
Dumaresq, Edward	Dumaresque, Edward	L'Anse Au Claire
Pilgrim, Daniel Neil	Stevens, Daniel Neil	Labrador City
Norman, Roxanne Audrey	McCormack, Roxane Audrey	St. John's
Savoury, Linsey Gail	Wagg, Linsey Gail	Massey Drive
Dumaresque, Payton Kiana	Hoffe, Payton Kiana Dumaresque	Labrador City
Locke, Ryan Gerald	King, Ryan Gerald	Corner Brook
Keats, Jacqueline Ivy Patricia	Cuff, Jacqueline Ivy Patricia	Gander
Pitts-Spurrell, Madalynn Angelina	Spurrell-Ahmed, Madalynn Angelina	Mount Pearl
Jensen, Brandon Joseph	Ford-Lewis, Brandon Joseph	Holyrood
Mitchell, Ryley Marie	Williams, Ryley Marie Danielle	Bay Bulls
Barry, Devon Thomas	Fitzpatrick, Devon Thomas	Flatrock
Clark, David Rex	Clarke, David Rex	Springdale
Collins, Monica Clare	Gregory, Monica Clare	Conception Bay South
Lavery, Lisa Margaret	Coombs, Lisa Margaret	Plum Point
Taylor, Darrin Shannon	Parsons, Darren Shannon	Brigus
Granter, Gordon Samuel	White, Gordon Samuel	Gander
Price, Ethan Steven	Larkin, Ethan Steven	Conception Bay South
Benuen, Brendan Leland	Rich, Brendan Leland	Sheshatshiu
Edmonds, Christopher Kenneth Clayton	Edmunds, Christopher Kenneth Clayton	Happy Valley-Goose Bay
Rich, Sonia Evelyn	Selma, Sonia Evelyn	Sheshatshiu
Neilson, Olga Marie	Nilsson, Olga Marie	Paradise
Penny, Madeline Elizabeth	Penney, Madelin Elizabeth	Paradise
Jacobs, Krystal Annette Nicole	Jane, Sadie	St. John's
Way, Lewis James	Waye, Lewis James	Bonavista
Wright, Cody Tyler	Elford, Cody Tyler	Corner Brook
Wright, Christopher Dylan	Elford, Christopher Dylan	Corner Brook
Wright, Tie Garland	Elford, Tie Garland	Corner Brook
Wright, Stephanie Ann	Elford, Stephanie Ann	Corner Brook

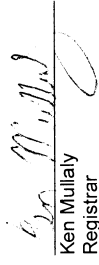
  
Ken Mullaly  
Registrar  
Vital Statistics

DEPARTMENT OF GOVERNMENT SERVICES  
Ken Mullaly, Registrar Vital Statistics



# THE NEWFOUNDLAND AND LABRADOR GAZETTE

## PART II

### SUBORDINATE LEGISLATION FILED UNDER THE STATUTES AND SUBORDINATE LEGISLATION ACT

---

Vol. 86

ST. JOHN'S, FRIDAY, FEBRUARY 25, 2011

No. 8

---

### NEWFOUNDLAND AND LABRADOR REGULATIONS

NLR 19/11  
NLR 20/11  
NLR 21/11  
NLR 22/11  
NLR 23/11  
NLR 24/11  
NLR 25/11  
NLR 26/11  
NLR 27/11  
NLR 28/11  
NLR 29/11



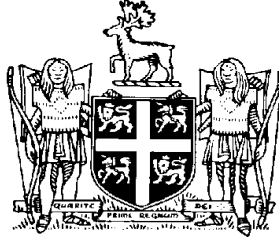

**NEWFOUNDLAND AND LABRADOR  
REGULATION 19/11**

*Open Season Big Game Caribou Hunting Order,  
Labrador, 2010-2011 (Amendment)*

under the  
*Wild Life Regulations*  
and the  
*Wild Life Act*

*(Filed February 22, 2011)*

Under the authority of sections 38, 92 and 114 of the *Wild Life Regulations* and the *Wild Life Act*, I make the following Order.

Dated at St. John's, February 10, 2011.

Ross Wiseman  
Minister of Environment and Conservation

**ORDER**

*Analysis*

- |                             |               |
|-----------------------------|---------------|
| 1. S.5 R&S<br>Closed season | 2. Sch. Amdt. |
|-----------------------------|---------------|

NLR 106/10

**1. Section 5 of the *Open Season Big Game Caribou Hunting Order, Labrador, 2010-2011* is repealed and the following substituted:**

Closed season

**5. There shall be a closed season in the following zones**

- (a) Double Mer Barrens Zone;
- (b) Grand Lake Zone;
- (c) Nipishish Lake Zone;
- (d) Mulligan River Zone;
- (e) Orma South Zone;
- (f) Seal Lake Zone;
- (g) Orma North Zone;
- (h) Michikamau East Zone;
- (i) Michikamau West Zone;
- (j) Twin Falls Zone;
- (k) Colville Lake Zone;
- (l) Sawbill Lake Zone;
- (m) Milner Lake Zone;
- (n) McPhayden River Zone;
- (o) Lac Virat Zone;
- (p) Red Wine Mountains Zone;
- (q) Goose Bay Zone; and
- (r) Metchin River Zone.

**2. The Schedule to the Order is amended by adding immediately after paragraph (r) the following:**

- (s) **Red Wine Mountains Zone**

All that area of Labrador commencing at the mouth of the Susan River located at 53° 44' 11.9" north latitude and 60° 59' 44.3" west longitude;

Then following the northern shorelines of Nardini Pond and Grand Lake in generally north easterly directly to the mouth of the Naskaupi River;

Then following the western bank of the Naskaupi River in generally north westerly direction to its confluence with the Red Wine River;

Then continuing to follow the western bank of the Naskaupi River in generally north westerly direction to its confluence with the Wapustan River;

Then following the northern bank of the Wapustan River in a generally westerly direction to the northern shoreline of a unnamed lake at its headwaters;

Then following the northern shoreline of said unnamed lake to its western extremity located at 54° 08' 20.4" north latitude and 61° 49' 49.6" west longitude;

Then following a straight line in a generally south westerly direction to the north shoreline of Pike Lake and its intersection with 62° 55' 41.0" west longitude;

Then following a straight line due south to the Metchin River outlet on an unnamed lake located at 53° 36' 04.9" north latitude and 62° 55' 41.0" west longitude;

Then following a straight line in a generally easterly direction to an unnamed lake at 53° 33' 44.3" north latitude and 60° 56' 31.1" west longitude;

Then following a straight line in a generally north westerly direction to the point of commencement.

**(t) Goose Bay Zone**

All that area of Labrador commencing at the mouth of the Susan River located at 53° 44' 11.9" north latitude and 60° 59' 44.3" west longitude;

Then following a straight line in a generally south easterly direction to a unnamed lake at 53° 33' 44.3" north latitude and 60° 56' 31.1" west longitude;

Then following 60° 56' 31.1" west longitude due south to its intersection with the Churchill River (Grand River);

Then following the northern bank of the Churchill River (Grand River) in a generally east by north east direction to Geys Point;

Then following the shoreline of Goose Bay to Sandy Point;

Then following the shoreline of Lake Melville to North West Point;

Then continuing to follow the shoreline of Lake Melville from North West Point to the main bridge at Sheshatsheits;

Then following the southern shoreline of the Little Lake in a generally north westerly direction to the southern bank of the "The Rapids";

Then following the southern shoreline of the "The Rapids" and Grand Lake in a generally north westerly direction to Nardini Pond;

Then following the southern shoreline of Nardini Pond to the mouth of the Susan River, the point of commencement.

**(u) Metchin River Zone**

All that area of Labrador commencing at the Metchin River outlet on an unnamed lake located at 53° 36' 04.9" north latitude and 62° 55' 41.0" west longitude;



Then following a straight line in a southerly direction to the intersection of a unnamed river and 62° 55' 41.0" west longitude;

Then following a straight line in a west by south west direction to the eastern extremity of an unnamed pond located at 53° 25' 44.1" north latitude and 62° 59' 21.3" west longitude;

Then following a straight line in a south westerly direction to the south eastern extremity of an unnamed pond located at 53° 24' 10.3" north latitude and 63° 02' 57.9" west longitude;

Then following a straight line in a south westerly direction to the intersection of a unnamed river and a unnamed pond located at 53° 23' 18.1" north latitude and 63° 04' 28.3" west longitude;

Then following a straight line in a south westerly direction to the western extremity of an unnamed pond located at 53° 20' 59.4" north latitude and 63° 06' 33.5" west longitude;

Then following 63° 06' 33.5" west longitude due south to its intersection with the north bank of the Wilson River;

Then following the north bank of the Wilson River in a generally westerly direction to its intersection with the Metchin River;

Then following the northwest bank of the Metchin River in a generally north easterly direction to the point of commencement.

**©Earl G. Tucker, Queen's Printer**



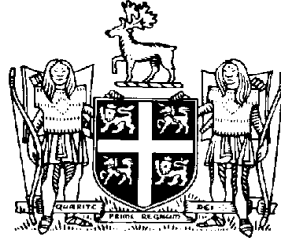

**NEWFOUNDLAND AND LABRADOR  
REGULATION 20/11**

*Notice of Wellhead Protected Water Supply Area of  
the Town of Port au Port West - Aguathuna - Felix Cove,  
#1 Marie Bell Well, WS-G-0574  
under the  
Water Resources Act*

*(Filed February 22, 2011)*

Under the authority of section 61 of the *Water Resources Act*, I designate the area known as the *Wellhead Protected Water Supply Area, #1 Marie Bell Well, WS-G-0574* for the Town of Port au Port West - Aguathuna - Felix Cove as a wellhead protected water supply area.

Dated at St. John's, February 3, 2011.

Ross Wiseman  
Minister of Environment and Conservation

**NOTICE**

This area includes all lands in the Provincial Electoral District of Port au Port abutted and bounded as follows:

By a circle of 100 metres radius with its centre being the Town of Port au Port West - Aguathuna - Felix Cove water supply #1 Marie Bell Well, having UTM coordinates northing 5,378,856 metres and easting 372,004 metres.

All coordinates refer to Zone 21 of the NAD 83 Universal Transverse Mercator Projection.

©Earl G. Tucker, Queen's Printer



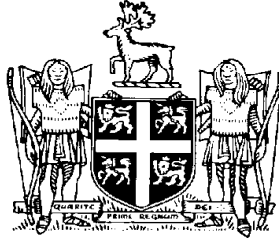

**NEWFOUNDLAND AND LABRADOR  
REGULATION 21/11**

*Notice of Wellhead Protected Water Supply Area of  
the Town of Port au Port West - Aguathuna - Felix Cove,  
#3 John McLean Well, WS-G-0574  
under the  
Water Resources Act*

*(Filed February 22, 2011)*

Under the authority of section 61 of the *Water Resources Act*, I designate the area known as the *Wellhead Protected Water Supply Area, #3 John McLean Well, WS-G-0574* for the Town of Port au Port West - Aguathuna - Felix Cove as a wellhead protected water supply area.

Dated at St. John's, February 3, 2011.

Ross Wiseman  
Minister of Environment and Conservation

**NOTICE**

This area includes all lands in the Provincial Electoral District of Port au Port abutted and bounded as follows:

By a circle of 100 metres radius with its centre being the Town of Port au Port West - Aguathuna - Felix Cove water supply #3 John McLean Well, having UTM coordinates northing 5,377,820 metres and easting 370,534 metres.

All coordinates refer to Zone 21 of the NAD 83 Universal Transverse Mercator Projection.

©Earl G. Tucker, Queen's Printer





**NEWFOUNDLAND AND LABRADOR  
REGULATION 22/11**

*Notice of Wellhead Protected Water Supply Area of  
the Town of Port au Port West - Aguathuna - Felix Cove,  
#4 Goose Pond Road Well, WS-G-0575  
under the  
Water Resources Act*

*(Filed February 22, 2011)*

Under the authority of section 61 of the *Water Resources Act*, I designate the area known as the *Wellhead Protected Water Supply Area, #4 Goose Pond Road Well, WS-G-0575* for the Town of Port au Port West - Aguathuna - Felix Cove as a wellhead protected water supply area.

Dated at St. John's, February 3, 2011.

Ross Wiseman  
Minister of Environment and Conservation

**NOTICE**

This area includes all lands in the Provincial Electoral District of Port au Port abutted and bounded as follows:

By a circle of 100 metres radius with its centre being the Town of Port au Port West - Aguathuna - Felix Cove water supply #4 Goose Pond Road Well, having UTM coordinates northing 5,377,785 metres and easting 368,417 metres.

All coordinates refer to Zone 21 of the NAD 83 Universal Transverse Mercator Projection.

©Earl G. Tucker, Queen's Printer





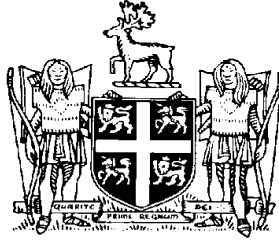

**NEWFOUNDLAND AND LABRADOR  
REGULATION 23/11**

*Notice of Wellhead Protected Water Supply Area of  
the Town of Port au Port West - Aguathuna - Felix Cove,  
#5 Oceanview Drive Well, WS-G-0576  
under the  
Water Resources Act*

*(Filed February 22, 2011)*

Under the authority of section 61 of the *Water Resources Act*, I designate the area known as the *Wellhead Protected Water Supply Area, #5 Oceanview Drive Well, WS-G-0576* for the Town of Port au Port West - Aguathuna - Felix Cove as a wellhead protected water supply area.

Dated at St. John's, February 3, 2011.

Ross Wiseman  
Minister of Environment and Conservation

**NOTICE**

This area includes all lands in the Provincial Electoral District of Port au Port abutted and bounded as follows:

By a circle of 100 metres radius with its centre being the Town of Port au Port West - Aguathuna - Felix Cove water supply #5 Oceanview Drive Well, having UTM coordinates northing 5,377,156 metres and easting 367,595 metres.

All coordinates refer to Zone 21 of the NAD 83 Universal Transverse Mercator Projection.

©Earl G. Tucker, Queen's Printer



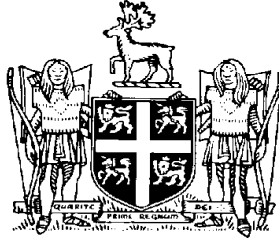

**NEWFOUNDLAND AND LABRADOR  
REGULATION 24/11**

*Notice of Wellhead Protected Water Supply Area of  
the Town of Port au Port West - Aguathuna - Felix Cove,  
#6 Father Joy's Well, WS-G-0574  
under the  
Water Resources Act*

*(Filed February 22, 2011)*

Under the authority of section 61 of the *Water Resources Act*, I designate the area known as the *Wellhead Protected Water Supply Area, #6 Father Joy's Well, WS-G-0574* for the Town of Port au Port West - Aguathuna - Felix Cove as a wellhead protected water supply area.

Dated at St. John's, February 3, 2011.

Ross Wiseman  
Minister of Environment and Conservation

**NOTICE**

This area includes all lands in the Provincial Electoral District of Port au Port abutted and bounded as follows:

By a circle of 100 metres radius with its centre being the Town of Port au Port West - Aguathuna - Felix Cove water supply #6 Father Joy's Well, having UTM coordinates northing 5,378,824 metres and easting 370,627 metres.

All coordinates refer to Zone 21 of the NAD 83 Universal Transverse Mercator Projection.

©Earl G. Tucker, Queen's Printer



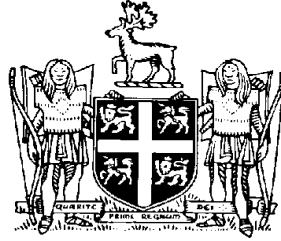

**NEWFOUNDLAND AND LABRADOR  
REGULATION 25/11**

*Vacated Communities of Great Harbour Deep,  
Petites and Big Brook Order*  
under the  
*Evacuated Communities Act*

*(Filed February 22, 2011)*

Under the authority of subsection 3(1) of the *Evacuated Communities Act*, I make the following regulations.

Dated at St. John's, February 3, 2011.

Kevin O'Brien  
Minister of Municipal Affairs

**ORDER**

*Analysis*

- |                       |              |
|-----------------------|--------------|
| 1. Short title        | 3. Petites   |
| 2. Great Harbour Deep | 4. Big Brook |

Short title                    **1.** This order may be cited as the *Vacated Communities of Great Harbour Deep, Petites and Big Brook Order*.

Great Harbour Deep       **2.** Great Harbour Deep is a vacated community effective November 1, 2002.

Petites                        **3.** Petites is a vacated community effective November 1, 2003.

Big Brook                    **4.** Big Brook is a vacated community effective October 15, 2004.

**©Earl G. Tucker, Queen's Printer**





**NEWFOUNDLAND AND LABRADOR  
REGULATION 26/11**

*Repeal of Notice of Protected Water Supply Area  
under the  
Water Resources Act*

*(Filed February 22, 2011)*

Under the authority of section 39 of the *Water Resources Act*, I give the following notice.

Dated at St. John's, February 3, 2011.

Ross Wiseman  
Minister of Environment and Conservation

**NOTICE**

**The *Notice of Protected Water Supply Area, Newfoundland and Labrador Regulation 53/98*, is repealed.**

©Earl G. Tucker, Queen's Printer





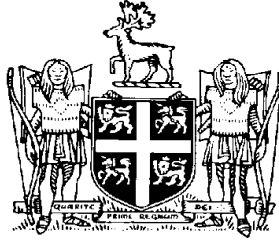

**NEWFOUNDLAND AND LABRADOR  
REGULATION 27/11**

*Notice of Wellhead Protected Water Supply Area of  
the Local Service District of Hopeall,  
Charles Cumby Well, WS-G-0802  
under the  
Water Resources Act*

*(Filed February 22, 2011)*

Under the authority of section 61 of the *Water Resources Act*, I designate the area known as the *Wellhead Protected Water Supply Area, Charles Cumby Well, WS-G-0802*, for the Local Service District of Hopeall as a wellhead protected water supply area.

Dated at St. John's, February 2, 2011.

Ross Wiseman  
Minister of Environment and Conservation

**NOTICE**

This area includes all lands in the Provincial Electoral District of Trinity - Bay de Verde abutted and bounded as follows:

By a circle of 100 metres radius with its centre being the Local Service District of Hopeall water supply Charles Cumby Well, having UTM coordinates northing 5,276,430 metres and easting 311,514 metres.

All coordinates refer to Zone 22 of the NAD 83 Universal Transverse Mercator Projection.

©Earl G. Tucker, Queen's Printer



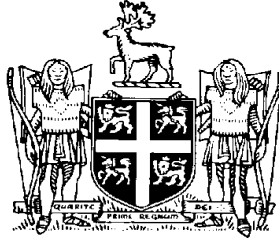

**NEWFOUNDLAND AND LABRADOR  
REGULATION 28/11**

*Notice of Wellhead Protected Water Supply Area of  
the Local Service District of Hopeall,  
Gilberts Hill Well, WS-G-0826  
under the  
Water Resources Act*

*(Filed February 22, 2011)*

Under the authority of section 61 of the *Water Resources Act*, I designate the area known as the *Wellhead Protected Water Supply Area, Gilberts Hill Well, WS-G-0826* for the Local Service District of Hopeall as a wellhead protected water supply area.

Dated at St. John's, February 2, 2011.

Ross Wiseman  
Minister of Environment and Conservation

**NOTICE**

This area includes all lands in the Provincial Electoral District of Trinity - Bay de Verde abutted and bounded as follows:

By a circle of 100 metres radius with its centre being the Local Service District of Hopeall water supply Gilberts Hill Well, having UTM coordinates northing 5,275,809 metres and easting 310,380 metres.

All coordinates refer to Zone 22 of the NAD 83 Universal Transverse Mercator Projection.

**©Earl G. Tucker, Queen's Printer**



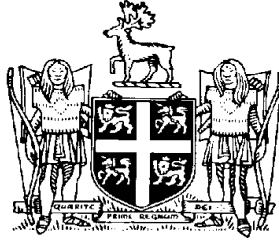

**NEWFOUNDLAND AND LABRADOR  
REGULATION 29/11**

*Rules of the Supreme Court, 1986 (Amendment)*  
under the  
*Judicature Act*

*(Filed February 22, 2011)*

Under the authority of section 55 of the Judicature Act, the Rules Committee of the Court of Appeal makes the following Rules.

Dated at St. John's, February 22, 2011.

Christopher P. Curran, Q.C.  
Registrar of the Supreme Court  
Secretary, Rules Committee

**RULES**

*Analysis*

1. Rule 57.15 Amdt.  
Factums

**1. Rule 57.15(6) of the *Rules of the Supreme Court, 1986* is amended by deleting the reference "rule 57.14(4)" and substituting the reference "rule 57.15(4)".**

©Earl G. Tucker, Queen's Printer



## Index

### PART I

City of Mount Pearl Act – Notice .....	58
Change of Name Act, 2009 – Notice .....	66
Lands Act – Notice .....	58
Mineral Act – Notice .....	57
Motor Carrier Act – Notice .....	59
Quieting of Titles Act – Notices .....	59
Trustee Act – Notices .....	65
Urban and Rural Planning Act – Notice .....	58

### PART II

#### CONTINUING INDEX OF SUBORDINATE LEGISLATION

Title of Act and Subordinate Legislation made thereunder	CNLR or NL Reg.	Amendment	NL Gazette Date & Page No.
<b>Evacuated Communities Act</b>			
Vacated Communities of Great Harbour Deep, Petites and Big Brook Order	NLR 25/11	New	Feb 25/11 p. 93
<b>Judicature Act</b>			
Rules of the Supreme Court, 1986	NLR 29/11	Rule 57.15 (b)	Feb 25/11 p. 101
<b>Water Resources Act</b>			
Notice of Wellhead Protected Water Supply Area of the Town of Port au Port West – Aguathuna – Felix Cove, #1 Marie Bell Well, WS-G-0574	NLR 20/11	New	Feb 25/11 p. 83
Notice of Wellhead Protected Water Supply Area of the Town of Port au Port West – Aguathuna – Felix Cove, #3 John McLean Well, WS-G-0574	NLR 21/11	New	Feb 25/11 p. 85
Notice of Wellhead Protected Water Supply Area of the Town of Port au Port West – Aguathuna – Felix Cove, #4 Goose Pond Road Well, WS-G-0575	NLR 22/11	New	Feb 25/11 p. 87

Title of Act and Subordinate Legislation made thereunder	CNLR or NL Reg.	Amendment	NL Gazette Date & Page No.
<b>Water Resources Act (cont'd)</b>			
Notice of Wellhead Protected Water Supply Area of the Town of Port au Port West – Aguathuna – Felix Cove, #5 Oceanview Drive Well, WS-G-0576	NLR 23/11	New	Feb 25/11 p. 89
Notice of Wellhead Protected Water Supply Area of the Town of Port au Port West – Aguathuna – Felix Cove, #6 Father Joy's Well, WS-G-0574	NLR 24/11	New	Feb 25/11 p. 91
Repeal of Notice of Protected Water Supply Area	NLR 26/11	Repeals NLR 53/98	Feb 25/11 p. 95
Notice of Wellhead Protected Water Supply Area of the Local Service District of Hopeall, Charles Cumby Well, WS-G-0802	NLR 27/11	New	Feb 25/11 p. 97
Notice of Wellhead Protected Water Supply Area of the Local Service District of Hopeall, Gilberts Hill Well, WS-G-0826	NLR 28/11	New	Feb 25/11 p. 99
<b>Wild Life Act and the Wild Life Regulations</b>			
Open Season Big Game Caribou Hunting Order, Labrador, 2010-2011 (Amdt)	NLR 19/11	Amends NLR 106/10 S.5 R&S Sch. Amdt	Feb 25/11 p. 77



*The Newfoundland and Labrador Gazette* is published from the office of Earl G. Tucker, Queen's Printer.

Copy for publication must be received before **Friday, 4:30 p.m.**, seven days before publication, to ensure inclusion in next issue.

Advertisements should be typewritten or printed legibly, separate from covering letter. Number of insertions required must be stated and the names of all signing officers typewritten or printed.

Copy may be mailed to the address below, faxed to (709) 729-1900 or emailed to [queensprinter@gov.nl.ca](mailto:queensprinter@gov.nl.ca).

Advertising rates are available upon request. Subscription rate for *The Newfoundland and Labrador Gazette* is \$125.00 for 52 weeks plus applicable tax (\$131.25). Weekly issues of \$3.00 per copy, plus tax payable in advance.

All cheques, money orders, etc., should be made payable to THE NEWFOUNDLAND EXCHEQUER ACCOUNT and all correspondence should be addressed to: Office of the Queen's Printer, P. O. Box 8700, Ground Floor, East Block, Confederation Building, St. John's, NL A1B 4J6. Telephone (709) 729-3649. Fax: (709) 729-1900.

Web Site: <http://www.gs.gov.nl.ca/printer/index.html>

**Place your order by contacting:  
Office of The Queen's Printer  
Confederation Building, East Block  
St. John's, NL A1B 4J6  
Telephone: (709) 729-3649 Fax: (709) 729-1900  
email: [queensprinter@gov.nl.ca](mailto:queensprinter@gov.nl.ca)**

**Government Information Product  
Publication Rate Mail**

**G.S.T. # R107442683**

**All requests for Subscription and Legislation MUST be prepaid.**

