



THE NEWFOUNDLAND AND LABRADOR GAZETTE

PART I

PUBLISHED BY AUTHORITY

Vol. 87

ST. JOHN'S, FRIDAY, APRIL 20, 2012

No. 16

CANADA-NEWFOUNDLAND ATLANTIC ACCORD IMPLEMENTATION ACT AND CANADA-NEWFOUNDLAND AND LABRADOR ATLANTIC ACCORD IMPLEMENTATION NEWFOUNDLAND AND LABRADOR ACT

CANADA-NEWFOUNDLAND AND LABRADOR OFFSHORE PETROLEUM BOARD CALL FOR BIDS No. NL12-02 (Area "C" – Flemish Pass)

The Canada-Newfoundland and Labrador Offshore Petroleum Board hereby gives notice of a call for the submission of bids in respect of one parcel in the Newfoundland and Labrador offshore area.

This notice of the Call for Bids No. NL12-02 is made pursuant and subject to the *Canada-Newfoundland Atlantic Accord Implementation Act*, S.C., 1987, c.3, and the *Canada-Newfoundland and Labrador Atlantic Accord Implementation Newfoundland and Labrador Act*, RSNL, 1990, cC-2.

The following is a summary of the Call for Bids No. NL12-02:

- (i) Sealed bids will be received by the Board prior to the time of closing of this call for bids. This call for bids will close at 4:00 p.m., Newfoundland Standard Time, on November 1, 2012, except as specifically provided for in the Call for Bids No. NL12-02.
- (ii) All bids must be submitted in accordance with the terms and conditions of the Call for Bids No. NL12-02.
- (iii) The parcel is located offshore Newfoundland and Labrador and is described in Schedule I. An Exploration Licence may be issued for this parcel.
- (iv) For the purpose of selecting a bid, the sole criterion to be used will be the total amount of money the bidder commits to expend on exploration on the parcel within Period I ("Work Expenditure Bid").
- (v) A minimum bid of \$1,000,000 will be required for this parcel in Area "C" - Flemish Pass.

- (vi) For the parcel, the Work Expenditure Bid must be accompanied by a bank draft or certified cheque in the amount of \$10,000 ("Bid Deposit") made payable to the Receiver General. Furthermore, the successful bidder will be required to provide, within 15 days of notification of being the successful bidder, a promissory note in the amount of 25% of the Work Expenditure Bid ("Security Deposit"). A credit against the Security Deposit will be made on the basis of 25% of allowable expenditures as described in the Exploration Licence ("Allowable Expenditures").
- (vii) The successful bidder will receive a refund, without interest, of the Bid Deposit when the Security Deposit is posted within 15 days. Failure to post the Security Deposit within 15 days will result in forfeiture of the Bid Deposit and disqualification of the bid.

Following the announcement of the bid results, the Bid Deposits of unsuccessful bidders will be returned, without interest, as soon as possible.

- (viii) The interest owner may at its option extend Period I from six years to seven years by providing to the Board before the end of the sixth year of Period I either:
 - (a) a description of 50% contiguous Licence Lands to be surrendered together with a refundable drilling deposit of \$1,000,000,

OR

 - (b) a \$5,000,000 refundable drilling deposit.

A drilling deposit posted pursuant to paragraph (a) or (b) above will be refunded in full if the Exploration Licence is validated for Period II by the drilling of a well on that Exploration Licence. No interest will be paid on the drilling deposit.

If a validation well is not drilled, the drilling deposit will be forfeited to the Receiver General for Canada upon termination of the Exploration Licence at the end of Period I. Allowable Expenditures cannot be applied against the drilling deposit.

- (ix) For the parcel, the licence requirement will be one well to be commenced within Period I and diligently pursued thereafter.
- (x) For the parcel, rentals will be applicable only in Period II at the following rates:

1 st year	\$5.00 per hectare
2 nd year	\$7.50 per hectare
3 rd year	\$10.00 per hectare

When an Exploration Licence continues in force beyond Period II, rentals will be payable at the rates applicable during the last year of Period II.

Rentals will be payable annually, in advance, and are to be submitted by cheque payable to the Receiver General, except for rentals applicable to an Exploration Licence continuing beyond Period II, which will be payable monthly, in advance, at the rate of one-twelfth (1/12) of the applicable annual rates.

Rentals will be refunded annually, to a maximum of 100% of the rentals paid in that year, on the basis of a dollar refund for each dollar of Allowable Expenditures for that year.

Carry forward provisions to reduce rentals otherwise payable in ensuing rental years will apply.

Rentals will apply to lands subject to a declaration of significant discovery during the term of the Exploration Licence at the rates and levels of refundability specified above.

- (xi) An Allowable Expenditure schedule will have application throughout Period I of the Exploration Licence. The rates of Allowable Expenditures will be reviewed, and may be amended, at the expiration of Period I.

(xii) Rentals (“Significant Discovery Licence”)

Each Significant Discovery Licence shall be subject to the following rental regime after the expiration of the term of the Exploration Licence of origin:

- (a) Rentals on Significant Discovery Licences, following the expiry date of the Exploration Licence, shall be at the following base rates:

Year 1 to 5	\$0.00 per hectare
Year 6 to 10	\$40.00 per hectare
Year 11 to 15	\$200.00 per hectare
Year 16 to 20	\$800.00 per hectare

The rental rates applicable to any Significant Discovery Licence resulting from Call for Bids No. NL12-02 will be payable in constant (inflation adjusted) 2013 dollars.

- (b) Rental rates of \$800.00 will increase by \$100.00 for each year beyond year 20, and will be payable in constant (inflation adjusted) 2013 dollars until the Significant Discovery Licence is relinquished or converted to a Production Licence. For greater certainty, the interest owner may relinquish lands to reduce future rental payments.
- (c) There shall be no carry forward of excess allowable expenditures from Exploration Licences.
- (d) Rentals are to be submitted by bank draft or certified cheque payable to the Receiver General for Canada.
- (e) For greater certainty, rentals shall be calculated on the basis of the total hectareage of lands held as part of the Significant Discovery Licence, as of the anniversary date.
- (f) Rentals will be refunded annually, to a maximum of one hundred percent (100%) of the rentals paid in that year, on the basis of a dollar refund for each dollar of allowable expenditures for that year.
- (xiii) A successful bidder will be required to comply with the Canada-Newfoundland and Labrador Benefits procurement, employment and reporting procedures as established by the Board in its *Exploration Benefits Plan Guidelines*.
- (xiv) Each parcel will be subject to the payment of issuance fees and Environmental Studies Research Fund levies.
- (xv) The Board is not obliged to accept any bid or issue any interest as a result of this call for bids.
- (xvi) Any licence that may be issued shall be in the form of the exploration licence attached to the Call for Bids No. NL12-02.

The full text of Call for Bids No. NL12-02 is available at the Board’s Web site (www.cnlopb.nl.ca) or upon request made to the Registrar, Canada-Newfoundland and Labrador Offshore Petroleum Board, TD Place, Fifth Floor, 140 Water Street, St. John’s, Newfoundland and Labrador, A1C 6H6, 709-778-1400.

CANADA-NEWFOUNDLAND AND LABRADOR OFFSHORE PETROLEUM BOARD
Max Ruelokke, P. Eng.
Chairman and Chief Executive Officer

**SCHEDULE I
LAND DESCRIPTION
CALL FOR BIDS NO. NL12-02
(Area "C" – Flemish Pass)**

	<u>Latitude*</u>	<u>Longitude*</u>	<u>Sections</u>	<u>Hectares</u>
Parcel No. 1	47°20'N	46°30'W	81-100	7 008
	47°20'N	46°45'W	1-100	35 040
	47°20'N	47°00'W	1-60	21 024
	47°10'N	46°30'W	81-100	7 030
	47°10'N	46°45'W	1-100	35 150
	47°10'N	47°00'W	1-60	21 090
	47°00'N	46°30'W	81-100	7 052
	47°00'N	46°45'W	1-100	35 260
	47°00'N	47°00'W	1-60	21 156
	46°50'N	46°45'W	75-80, 85-90, 95-100	6 363
	46°50'N	47°00'W	5-10, 15-20, 25-30, 35-40, 45-50, 55-60	12 726
			Total Hectares	208 899

*North American Datum 1927

Apr 20

CORPORATIONS ACT					
			2012-02-03	66782	JARS Investments Inc.
			2012-02-03	66783	Happy Valley - Goose Bay Housing & Homelessness Coalition Inc.
<i>Corporations Act - Section 393</i>					
<i>Local Incorporations</i>					
<i>For the Month of: February 2012</i>			2012-02-06	66800	LAB WEST ULTRA-LIGHT INC.
Date	Number	Company Name	2012-02-06	66795	NEWFOUNDLAND SEARCH DOGS INC.
2012-02-01	66762	ABBOTT'S AUTOGRAPHICS INC	2012-02-06	66798	THE WHITEWAY FIFTY-PLUS CLUB INC.
2012-02-01	66766	ALIAN T MEMORIAL FOUNDATION CORP	2012-02-06	66794	LAST INSPECTION LTD.
2012-02-01	66763	G & J BACKHOE SERVICES INC.	2012-02-07	66804	FRATIAN INVESTMENTS LIMITED
2012-02-01	66764	PANGAEA ENERGY LIMITED	2012-02-07	66801	Reno Solutions Inc
2012-02-01	66765	SKYLE DEVELOPMENTS INC.	2012-02-07	66802	A & N HOLDINGS LTD.
2012-02-01	66744	Elegant Homes Construction Ltd	2012-02-07	66803	66803 NEWFOUNDLAND & LABRADOR INC.
2012-02-01	66753	Crystal North Professional Services Inc.	2012-02-08	66812	BARTON'S AUTOMOTIVE INC.
2012-02-01	66754	Itam Holdings Inc.	2012-02-09	66819	GOODWILL GAMING, INC.
2012-02-01	66755	Puddy Holdings Inc.	2012-02-09	66816	MAID, RIGHT HERE! LTD.
2012-02-01	66756	Redeekulous Custom Decks and Fencing Inc.	2012-02-09	66814	Savage Cove Community Development Inc.
2012-02-01	66757	Vinland Homes Inc.	2012-02-09	66815	Rock 5 Studios Inc.
2012-02-01	66758	66758 NEWFOUNDLAND & LABRADOR INC.	2012-02-10	66838	66838 NEWFOUNDLAND & LABRADOR LTD.
2012-02-01	66759	DF 51 Consulting Ltd.	2012-02-10	66821	A.F. WELDING & IRONWORKS LTD.
2012-02-02	66776	66776 NEWFOUNDLAND & LABRADOR LTD.	2012-02-10	66822	BODYWORKS ST. JOHN'S (2012) LTD.
2012-02-02	66777	SEAFORCE PROPERTIES INC.	2012-02-10	66832	BYRON & DONNA'S RENOS LTD.
2012-02-02	66760	Lure Enterprises Inc.	2012-02-10	66834	COST DEFLATION INC.
2012-02-02	66771	Canning's Grocery Ltd.	2012-02-10	66823	DAVID RANDELL PROFESSIONAL CORPORATION
2012-02-02	66773	Technical Welding Solutions Inc.			
2012-02-03	66784	CBTG'S BAR INCORPORATED			
2012-02-03	66785	COLEMAN MAT AND MARINE LTD.	2012-02-10	66825	DR. C. E. O'MAONAIGH PROFESSIONAL MEDICAL CORPORATION
2012-02-03	66786	FUSS CONSTRUCTION INC.			
2012-02-03	66789	LINCO DOOR SERVICES LTD.			
2012-02-03	66790	PRESTIGE EAST TAXI LIMITED			
2012-02-03	66780	Deer Lake Orangestore Limited			
2012-02-03	66781	Crossroads Orangestore Limited			

THE NEWFOUNDLAND AND LABRADOR GAZETTE
April 20, 2012

2012-02-10	66831	JAM MACKEY'S GRANITE, MARBLE & MOSAIC IMPORT-EXPORT INC.	2012-02-17	66897	B.G. HISCOCK FISHERIES LIMITED
2012-02-10	66817	Bennett Holdings Inc.	2012-02-17	66896	BLACKSTAR SOLUTIONS INC.
2012-02-10	66818	Twillingate Realty Inc.	2012-02-17	66894	GREG HICKEY CONTRACTING INC
2012-02-13	66847	ALSPEC ROOFING AND CONTRACTING LIMITED	2012-02-17	66898	T. DURDLÉ FISHERIES LIMITED
2012-02-13	66848	DEER LAKE TAXI 87 LIMITED	2012-02-17	66895	TOW FAST INC.
2012-02-13	66846	THE HUNTING PARTY INC.	2012-02-17	66876	Nitassinan Supplies Inc.
2012-02-13	66820	Blackbridge United Corp.	2012-02-20	66904	CEDAR CONTRACTING CORP
2012-02-13	66839	Beer Essentials Inc.	2012-02-20	66907	SIKU HOLDINGS LTD.
2012-02-13	66841	CPZ Operators Inc.	2012-02-20	66905	XTREME SALON & TANNING INC.
2012-02-14	66852	A B A MAINTENANCE & CONTRACTING LTD.	2012-02-20	66900	66900 NEWFOUNDLAND & LABRADOR LIMITED
2012-02-14	66853	HUMAN CAPITAL ASSURANCE CORPORATION	2012-02-20	66901	Pelley's Piping Inc.
2012-02-14	66854	J & B ENVIRONMENTAL SOLUTIONS INC.	2012-02-20	66902	66902 NEWFOUNDLAND & LABRADOR INC.
2012-02-14	66855	KMK LEGAL SERVICES PLC INC.	2012-02-20	66903	H and P Enterprises Limited
2012-02-14	66851	VILLAHERMOSA CLEANING SERVICE LTD.	2012-02-21	66919	LAKE MELVILLE SHRINE CLUB INC
2012-02-14	66849	Katherine Stringer Investments Inc.	2012-02-21	66911	M2P DEVELOPMENTS INC.
2012-02-14	66850	T&T Safety Services Limited	2012-02-21	66917	SYLVIA'S BED & BREAKFAST INC
2012-02-15	66870	2014 NEWFOUNDLAND AND LABRADOR WINTER GAMES HOST COMMITTEE – CLARENVILLE INC.	2012-02-21	66912	PARTY NEWFOUNDLAND ENTERTAINMENT HOLDINGS LIMITED
2012-02-15	66867	FRATELLI INVESTMENT HOLDINGS LTD.	2012-02-21	66913	KMK Financing Inc.
2012-02-15	66873	HAGERTY PENASHUE HOLDINGS INC.	2012-02-21	66914	Work Global Canada Inc.
2012-02-15	66866	LAWLOR'S EXCAVATING INC.	2012-02-22	66924	E. FLYNN HOLDINGS INC.
2012-02-15	66871	N.L. BASEMENT SYSTEMS & FOUNDATION REPAIR LIMITED	2012-02-22	66920	Weldex Inspection Services Limited
2012-02-15	66868	PWC 2012 REUNION INC.	2012-02-22	66921	HAPPY BELLY BAKERY INC
2012-02-15	66869	TAG ENTERPRISES LTD.	2012-02-22	66922	BUCKLE'S CONTRACTING LIMITED
2012-02-15	66863	TRICOLOUR SOFTWARE INC.	2012-02-22	66923	SCB Holdings (2012) Inc.
2012-02-15	66865	WHITE SAIL TRADING LTD.	2012-02-23	66933	66933 NEWFOUNDLAND AND LABRADOR LTD.
2012-02-15	66856	Three Rapids Expediting Services Ltd.	2012-02-23	66937	COMBINED SERVICE CONTRACTING INC.
2012-02-15	66857	66857 NEWFOUNDLAND & LABRADOR INC.	2012-02-23	66938	DR. LYNNA NASERI ORTHODONTIST INC.
2012-02-15	66858	66858 NEWFOUNDLAND & LABRADOR INC.	2012-02-23	66932	K. M. C. CONTRACTING INC.
2012-02-15	66859	66859 NEWFOUNDLAND & LABRADOR INC.	2012-02-23	66935	KERRIVAN FISHERIES LTD.
2012-02-16	66882	66882 NEWFOUNDLAND AND LABRADOR LIMITED	2012-02-23	66936	MULROONEY FISHERIES LTD.
2012-02-16	66889	66889 NEWFOUNDLAND AND LABRADOR INC.	2012-02-23	66925	Viking Property Security Service Inc.
2012-02-16	66890	66890 NEWFOUNDLAND AND LABRADOR INC.	2012-02-23	66926	Viking Property Security Service Inc.
2012-02-16	66888	ASH DRYWALL LIMITED	2012-02-23	66927	Tripple B Contracting Ltd
2012-02-16	66878	BRIAN'S AUTO SALES LTD.	2012-02-23	66928	Reliable Reno's Inc.
2012-02-16	66881	FOK HOLDINGS LIMITED	2012-02-23	66929	RSA Glass Repair Ltd.
2012-02-16	66885	GEORGE'S INSPECTING SERVICES LIMITED	2012-02-23	66929	JCK Enterprises Ltd.
2012-02-16	66886	LE ROX HOLDINGS INC.	2012-02-23	66930	TDH Subsea Consulting Inc.
2012-02-16	66891	NEXUS ENERGY INC.	2012-02-24	66943	M.G.M.A. INDUSTRIAL CLEANING INC.
2012-02-16	66879	RJR HOLDINGS LIMITED	2012-02-24	66947	NEWFOUNDLAND AND LABRADOR MILITARY MUSEUM INC.
2012-02-16	66880	ROK HOLDINGS LIMITED	2012-02-24	66944	SCJ CONSULTANTS LTD
2012-02-16	66887	WITLESS BAY RETIREMENT CENTRE INC.	2012-02-24	66931	Smith's Harbour Come Home Year Committee Inc.
2012-02-16	66860	L N E ENTERPRISES LTD	2012-02-24	66939	66939 NEWFOUNDLAND & LABRADOR INC.
2012-02-16	66872	Business Analyst Consulting Inc.	2012-02-24	66940	Modern Affair Inc.
2012-02-16	66874	Newfound Forming Limited	2012-02-27	66960	CANADIAN RENOVATIONS LTD
2012-02-16	66875	Home Taste Brewing Ltd	2012-02-27	66966	DR. NABIL OUATIK PEDIATRIC DENTISTRY CORPORATION
			2012-02-27	66961	LEVEE NIGHTLIFE INC.
			2012-02-27	66962	SECOND GENERATION INTERIOR CONTRACTING LTD
			2012-02-27	66965	SOUTHERN SHORE SNOW FISHERIES LIMITED
			2012-02-27	66941	D.A. Family Investments Limited

THE NEWFOUNDLAND AND LABRADOR GAZETTE
April 20, 2012

2012-02-27	66942	R.A. Family Investments Limited	2012-02-06	13930	M. D. & K. AGENCIES LIMITED
2012-02-27	66949	Frank Palmer Consultants Ltd.	2012-02-06	7114	T.P.L. Limited
2012-02-27	66950	Boom I.T. Data and Network Cabling Inc.	2012-02-06	43776	The Head Room Inc.
2012-02-27	66951	Triton Hardware Limited	2012-02-07	28286	B & F Enterprises Ltd.
2012-02-27	66953	GMJ Enterprises Ltd.	2012-02-07	23226	PAUL PARSONS TRUCKING LTD.
2012-02-28	66970	ACCURATE ROOFING & WINDOWS INC.	2012-02-07	39253	REFUGEE and IMMIGRANT ADVISORY COUNCIL INC.
2012-02-28	66972	PROVINCIAL HOLDINGS LTD.	2012-02-08	65150	EASTSIDE CONTRACTING LTD.
2012-02-28	66954	David Adams Investments Limited	2012-02-08	65674	GH QUALITY INSPECTIONS INC.
2012-02-28	66955	Roy Adams Investments Limited	2012-02-08	20816	M.V. SAVAGE FOAM LIMITED
2012-02-28	66956	David Adams TIM-BR Mart Holdings Limited	2012-02-08	59420	UMBRELLA SECURITY SERVICES INC.
2012-02-28	66957	Roy Adams TIM-BR Mart Holdings Limited	2012-02-09	58126	VESSEL SAFETY & MAINTENANCE MANAGEMENT (VSM2S) SYSTEM INC
2012-02-28	66958	David Adams Construction Holdings Limited	2012-02-10	54962	BURIN PENINSULA WASTE MANAGEMENT CORPORATION
2012-02-28	66959	Roy Adams Construction Holdings Limited	2012-02-10	37132	Nunak Land Corporation
2012-02-28	66967	Bower's Construction Co Ltd	2012-02-10	38763	POST MILL LUMBER INCORPORATED
2012-02-28	66968	Big River Camps (2012) Inc.	2012-02-10	16134	ROBERT HAYWARD & SONS LIMITED
2012-02-28	66969	JAC Estates Inc.	2012-02-10	65562	TBS Consulting Inc.
2012-02-29	66975	66975 NEWFOUNDLAND AND LABRADOR INC.	2012-02-10	28886	TORNGAIT UJAGANNIAVINGIT CORPORATION
2012-02-29	66979	LIVE OCEAN INC.	2012-02-13	65149	His Secret Place Inc.
2012-02-29	66984	MRCW HOLDINGS INC.	2012-02-14	12918	Howden Enterprises Limited
2012-02-29	66980	NL PROCESS SERVICES INC.	2012-02-14	66713	K & T FISHING CONSULTANTS INC.
2012-02-29	66982	RADIANT360 SOLUTIONS INC.	2012-02-16	57049	CLAYTON HOSPITALITY INC.
2012-02-29	66976	Air Ride Entertainment Limited	2012-02-16	50039	G.D. SALES, SERVICE AND RENTALS LIMITED
2012-02-29	66977	Digital Advertising Network Inc.	2012-02-16	11751	INDEPENDENT LIVING RESOURCE CENTER INCORPORATED
2012-02-29	66978	KOLJAX ENTERPRISES INC.	2012-02-16	44326	10981 NEWFOUNDLAND LIMITED
Total Incorporations: 165			2012-02-17	42680	CHARLES R. BELL LIMITED
<i>Corporations Act - Section 331</i>			2012-02-20	42504	42504 NEWFOUNDLAND & LABRADOR LTD.
Local Revivals			2012-02-20	61144	61144 NEWFOUNDLAND AND LABRADOR INC.
For the Month of: February 2012			2012-02-20	64001	MUSTANG SALLY'S FLAMING SKILLET (2012) LTD.
Date	Number	Company Name	2012-02-21	26813	BATTLE HARBOUR HISTORIC TRUST INC.
2012-02-02	22930	C.W.J.C. Transmission Limited	2012-02-21	66587	DR. DAVID FLUSK PROFESSIONAL MEDICAL CORPORATION
2012-02-03	46086	ECONOMY GLASS LTD.	2012-02-21	6783	Hub Electric Limited
2012-02-08	49035	Community Action Group for Adults with Developmental Disabilities Incorporated	2012-02-21	63403	MDN FINANCIAL SERVICES INC.
2012-02-16	39316	Atlantic Mussel Growers Newfoundland Limited	2012-02-22	57467	DURALITE HOLDINGS INC.
2012-02-16	17178	LABRADOR HUSKIES OLDTIMERS ATHLETIC ASSOCIATION	2012-02-23	25067	JARMAK INC.
2012-02-21	6783	Hub Electric Limited	2012-02-23	64066	Royal Construction Ltd
2012-02-28	25060	Collis Developments Inc.	2012-02-24	66717	DR. ALICIA KEEFE PROFESSIONAL DENTAL CORPORATION
Total Revivals: 7			2012-02-24	51437	GARRISON HILL ENTERTAINMENT LTD.
<i>Corporations Act - Section 286</i>			2012-02-24	22068	Health And Educational Services Inc.
Local Amendments			2012-02-24	59203	MCM MARINE INC.
For the Month of: February 2012			2012-02-24	15618	Newfoundland and Labrador Athletics Association Inc.
Date	Number	Company Name	2012-02-27	27585	Cro-at Developments Inc.
2012-02-01	44113	Precision Machine Works Inc.	2012-02-27	65101	NEWFOUNDLAND UNDERWATER SERVICES LTD.
2012-02-02	49803	49803 NEWFOUNDLAND & LABRADOR LIMITED	2012-02-28	12015	A. & A. REALTY COMPANY LIMITED
2012-02-02	46556	MAD ROCK MARINE SOLUTIONS INC.			
2012-02-03	37194	Dietrac Technical Institute Inc.			
2012-02-03	46086	ECONOMY GLASS LTD.			
2012-02-06	64895	2012 CDDC NEWFOUNDLAND AND LABRADOR COMMITTEE, INC			

THE NEWFOUNDLAND AND LABRADOR GAZETTE
April 20, 2012

2012-02-28 25824 B. A. TUCKER LTD.
2012-02-28 32300 McGrath-Kelly Company
Incorporated
2012-02-29 37748 COS LIMITED

Total Amendments: 52

Corporations Act - Section 335

Local Dissolutions
For the Month of: February 2012

Date	Number	Company Name
2012-02-02	18638	B. & C. BUILDING SUPPLIES LIMITED
2012-02-02	47405	Iceberg Harvesters Inc.
2012-02-06	39764	BALTIC SERVICES (1998) INC.
2012-02-06	64496	Bridgeless Ships Inc.
2012-02-07	60669	HONEYDO CONSTRUCTION & RENOVATIONS INC.
2012-02-08	52384	GRAY'S DELIVERY LTD
2012-02-08	60387	INSPIRING INDEPENDENT LEARNING CONSULTONS LTD.
2012-02-09	57992	57992 NEWFOUNDLAND AND LABRADOR LIMITED
2012-02-09	62717	I-AUTO-N-MORE INC.
2012-02-10	17736	DAWE'S GULF LIMITED
2012-02-10	25348	Skanes Enterprises Inc.
2012-02-10	14088	Tri Ocean Newfoundland Limited
2012-02-13	22413	W.A. ENTERPRISES LIMITED
2012-02-14	56769	56769 NEWFOUNDLAND & LABRADOR INCORPORATED
2012-02-15	9061	A. & B. Electrical Limited
2012-02-15	47910	Harvey's Purchasing Services Inc.
2012-02-15	47614	JELLY BY GEMINI LIMITED
2012-02-15	47802	New Found Adventures Inc.
2012-02-16	16089	Neville's Store Limited
2012-02-16	11601	Slimdown Limited
2012-02-17	54892	NORTH ATLANTIC SOLAR LTD.
2012-02-17	33484	WHJ Fishing Enterprises Ltd
2012-02-20	62193	62193 NEWFOUNDLAND AND LABRADOR LIMITED
2012-02-21	30410	Blackbird Investments Limited
2012-02-21	66007	FITZ'S DRAFTING LTD.
2012-02-22	64333	DR. R. RUDLAND PMC INC.
2012-02-22	34031	The Tommy Sexton Project, Inc.
2012-02-23	60187	EASTERN MACHINING & WELDING INC.
2012-02-23	59437	H I S ENTERPRISES LTD.
2012-02-23	60233	TRANSPORT I INC.
2012-02-24	52087	SABRAW SALES INC.
2012-02-24	24383	Utilitech Services Limited
2012-02-27	37220	GOUDIECO LTD.
2012-02-27	10567	M. J. Melenchuk (1978) Limited
2012-02-27	3713	R.E. INNES LIMITED
2012-02-28	55346	SOTER SAFETY INC.
2012-02-29	57393	SALT WATER ROOFING INC.

Total Dissolutions: 37

Corporations Act - Section 299
Local Discontinuances
For the Month of: February 2012

Date	Number	Company Name
2012-02-01	42508	CASELL HOLDINGS INC.
2012-02-10	43006	River Services Inc.
2012-02-13	59039	DR. E. HUNT PROFESSIONAL MEDICAL CORPORATION
2012-02-14	58589	ELPITHA ENTERPRISES INC.
2012-02-15	18322	VOGUE OPTICAL LIMITED

Total Discontinuances: 5

Corporations Act - Section 294

Local Amalgamations
For the Month of: February 2012

Date	Number	Company Name
2012-02-01	66772	MCCARTHY'S HEATING SERVICE LIMITED
From:	66429	66429 NEWFOUNDLAND & LABRADOR INC.
	18083	McCarthy's Heating Service Limited
2012-02-01	66770	N.P. INVESTMENTS LIMITED
From:	19255	N. P. Investments Limited
	33621	R. & D. Holdings Ltd.
2012-02-17	66899	METAL WORLD INC.
From:	4499	Butler Enterprises Limited
	28918	METAL WORLD INC.
	4076	Offshore Supplies International Inc.
2012-02-21	66918	CHOON KIT COMPANY LTD.
From:	31095	Choon Kit Company Ltd.
	34337	CHOON KIT HOLDINGS INC.
2012-02-24	66952	GANDER AREA COMMUNITY DEVELOPMENT CORPORATION
From:	35268	Gander Area Community Development Corporation
	17888	GANDER AREA DEVELOPMENT CORPORATION LIMITED

Total Amalgamations: 5

Corporations Act - Section 286

Local Name Changes
For the Month of: February 2012

Number	Company Name
65150	EASTSIDE CONTRACTING LTD.
2012-02-08	From: 1. Eastside Contracting Ltd.
65674	GH QUALITY INSPECTIONS INC.
2012-02-08	From: Bluff Inspections Inc.
58126	VESSEL SAFETY & MAINTENANCE MANAGEMENT (VSM2S) SYSTEM INC
2012-02-09	From: ATLANTIC NORTH SEAFOODS CORPORATION

THE NEWFOUNDLAND AND LABRADOR GAZETTE
April 20, 2012

66713		K & T FISHING CONSULTANTS INC.	2012-02-21	66916	ADDISON CHEVROLET BUICK GMC LIMITED
2012-02-14	From:	K & T CONSULTANTS INC.	2012-02-23	66934	TERRY HOOPER CONSULTING LTD.
64001		MUSTANG SALLY'S FLAMING SKILLET (2012) LTD.	2012-02-24	66945	CROMA PHARMA CANADA LTD.
2012-02-20	From:	Niraj Trading Corp	2012-02-24	66946	PHYSIO-CONTROL CANADA SALES LTD.
66587		DR. DAVID FLUSK PROFESSIONAL MEDICAL CORPORATION	2012-02-27	66963	BODKIN CAPITAL CORPORATION
2012-02-21	From:	66587 NEWFOUNDLAND & LABRADOR INC.	2012-02-27	66964	BODKIN LEASING CORPORATION
			2012-02-28	66973	ALTUS SECURITIES INC.
			2012-02-29	66981	BEACON ROOFING SUPPLY CANADA COMPANY
Total Name Changes: 6			2012-02-29	66986	CABOX ENTERPRISES LTD.
			2012-02-29	66985	SUN LIFE GLOBAL INVESTMENTS (CANADA) INC.
					PLACEMENTS MONDIAUX SUN LIFE (CANADA) INC.

Corporations Act - Section 443
Extra-Provincial Registrations
For the Month of: February 2012

Date	Number	Company Name
2012-02-01	66767	INDUSTRIAL SERVICE SOLUTIONS (ISS) CANADA LTD.
2012-02-01	66769	XEROX FINANCIAL SERVICES CANADA LTD./ SERVICES FINANCIERS XEROX CANADA LTÉE.
2012-02-02	66778	ALPHA TECHNOLOGIES LTD.
2012-02-02	66779	ESP-IT EXPERT SOLUTIONS PROVIDERS INC.
2012-02-02	66775	PRODUCT REMANUFACTURING CENTERS CANADA, LIMITED CENTRES DE REMISE À NEUF DE PRODUITS CANADA, LIMITÉE
2012-02-03	66791	3259401 NOVA SCOTIA COMPANY/3259401 COMPAGNIE DE LA NOUVELLE-ÉCOSSE
2012-02-03	66787	ALLOVER MEDIA, INC.
2012-02-03	66792	B2B TRUSTCO
2012-02-03	66793	PANAGO PIZZA INC.
2012-02-06	66796	7929552 CANADA INC.
2012-02-06	66797	CARDTRONICS CANADA, LTD.
2012-02-08	66810	ALL-TECH ENVIRONMENTAL SERVICES LIMITED
2012-02-10	66827	2281461 ONTARIO INC.
2012-02-10	66835	CANOE 2012 GENERAL PARTNER CORP.
2012-02-10	66829	FLSMIDTH SALT LAKE CITY, INC.
2012-02-10	66826	PRIME FASTENERS MARITIMES LIMITED
2012-02-10	66824	SAFETY INSURANCE SERVICES (ATLANTIC) LTD.
2012-02-13	66843	FLUOR INDUSTRIAL CONSTRUCTION CORP.
2012-02-13	66842	NBIMC REALTY CORP.
2012-02-13	66844	TW INSURANCE BROKERS INC.
2012-02-15	66862	8066388 CANADA INC.
2012-02-15	66861	GLENCORE LTD.
2012-02-15	66864	KMW DESIGN GROUP INC.
2012-02-16	66883	8094721 CANADA INC.
2012-02-16	66877	BINARY DAWN INTERACTIVE (2012) INC.
2012-02-16	66884	WALTON WESTPHALIA DEVELOPMENT CORPORATION
2012-02-17	66892	UNITED AIR LINES, INC.
2012-02-20	66909	FLSMIDTH LTD.
2012-02-20	66908	MICHAEL ROSSY LTÉE

Total Registrations: 39

Corporations Act - Section 451
Extra-Provincial Name Changes
For the Month of: February 2012

Number	Company Name
66788	CATERPILLAR MINING CANADA LIMITED
2012-02-03	From: BUCYRUS CANADA LIMITED
2012-02-03	From: CATERPILLAR MINING CANADA LIMITED
66788	CATERPILLAR MINING CANADA ULC
2012-02-03	From: BUCYRUS CANADA LIMITED
2012-02-03	From: CATERPILLAR MINING CANADA LIMITED
54833	DATA GROUP LTD.
2012-02-03	From: DATA BUSINESS FORMS LIMITED/FORMULES D'AFFAIRES DATA LIMITÉE
2012-02-03	From: DATA GROUP LTD.
54833	DATA GROUP LTD /GROUPE DATA LTÉE
2012-02-03	From: DATA BUSINESS FORMS LIMITED/FORMULES D'AFFAIRES DATA LIMITÉE
2012-02-03	From: DATA GROUP LTD.
5731F	EULER HERMES NORTH AMERICA INSURANCE COMPANY
2012-02-03	From: EULER HERMES AMERICAN CREDIT INDEMNITY COMPANY
63207	GCIC LTD./GCIC LTEE
2012-02-03	From: GOODMAN & COMPANY, INVESTMENT COUNSEL LTD. /GOODMAN & COMPANY, CONSEIL EN PLACEMENTS LTEE
63600	SOPREMA INC.
2012-02-07	From: SOPREMA CANADA INC.

THE NEWFOUNDLAND AND LABRADOR GAZETTE
April 20, 2012

66840		PALMER ATLANTIC INSURANCE LTD.	From:	4067D	APPLIED BIOSYSTEMS (CANADA) LIMITED/ APPLIED BIOSYSTEMES (CANADA) LIMITEE
2012-02-10		SAFETY INSURANCE SERVICES (ATLANTIC) LTD.			
894F		0909266 B.C. LTD.	2012-02-07	66805	4536631 CANADA INC.
2012-02-16		0909266 B.C. LTD.3894F	From:	53463	4338553 CANADA INC.
2012-02-16		OIL-DRI CANADA ULC			
		0909266 B.C. LTD.	2012-02-07	66807	KERRY (CANADA) INC.
53508		RADIUS FINANCIAL INC./FINANCIÈRE RADIUS INC.	From:	4293F	KERRY (CANADA) INC.
2012-02-21		MYNEXT MORTGAGE COMPANY LIMITED	2012-02-07	66806	SGS CANADA INC.
			From:	62206	SGS CANADA INC.
66948		GL NOBLE DENTON CANADA LIMITED	2012-02-08	66809	CASCO INC.
2012-02-24		HOLDING SERVICES	From:	63162	CASCO INC.
		INDUSTRIELS			
		GERMANISCHER LLOYD (CANADA) INC./	2012-02-08	66811	CLIFFS QUEBEC IRON MINING LIMITED
		GERMANISCHER LLOYD INDUSTRIAL SERVICES	From:	66070	CLIFFS QUÉBEC MINE DE FER LIMITÉE
		HOLDING (CANADA) INC.			CLIFFS QUEBEC IRON MINING LIMITED CLIFFS QUÉBEC MINE DE FER LIMITÉE
64601		CODE FIRE INC.			
2012-02-27		7781300 CANADA INC.	2012-02-08	66808	SIEMENS CANADA LIMITED
64059		INOVA COURTIER D'ASSURANCES INC.	From:	63664	SIEMENS CANADA LIMITEE
		INOVA INSURANCE			SIEMENS CANADA LIMITED
		BROKERS INC.		60075	SIEMENS CANADA LIMITEE
2012-02-27		INOVA S.M.S. COURTIER D'ASSURANCES INC./			SIEMENS HEALTHCARE DIAGNOSTICS LTD.
		INOVA S.M.S. INSURANCE			SIEMENS DIAGNOSTICS EN SOINS DE SANTÉ LTÉE
		BROKERS INC.	2012-02-10	66830	AECON CONSTRUCTION GROUP INC.
Total Name Changes: 14					
<hr/>					
<i>Corporations Act - Section 294</i>					
<i>Extra-Provincial Registrations for Amalgamation</i>					
<i>For the Month of: February 2012</i>					
Date	Number	Company Name			
2012-02-01	66761	DALE PARIZEAU MORRIS MACKENZIE INC.		6805F	AECON CONSTRUCTION GROUP INC./
From:	59658	DALE PARIZEAU MORRIS MACKENZIE INC.			GROUPE CONSTRUCTION AECON INC.
2012-02-01	66768	OLIVIERI FOODS LIMITED/ LES ALIMENTS OLIVIERI LIMITEE	2012-02-10	66828	NORTHBRIDGE FINANCIAL CORPORATION
From:	5384F	OLIVIERI FOODS LIMITED LES ALIMENTS OLIVIERI LIMITEE	From:	62953	CORPORATION FINANCIERE NORTHBRIDGE
2012-02-02	66774	ASTON HILL ASSET MANAGEMENT INC.			LOMBARD CANADA LTD. – LOMBARD DU CANADA LTÉE
From:	66354	ASTON HILL ASSET MANAGEMENT INC.	2012-02-10	66840	PALMER ATLANTIC INSURANCE LTD.
	51683	ASTON HILL INVESTMENTS INC.	From:	66837	SAFETY INSURANCE SERVICES (ATLANTIC) LTD.
	66549	ASTON HILL MW GP INC.	2012-02-10	66836	ROPAK CANADA INC.
	52155	MORRISON WILLIAMS CAPITAL ADVISORS INC.	From:	3250D	LOGTEK LOGISTICS CANADA INC.
2012-02-03	66788	CATERPILLAR MINING CANADA ULC		3893F	Ropak Canada Inc.
From:	4812F	BUCYRUS CANADA LIMITED	2012-02-10	66833	SAFETY INSURANCE SERVICES (ATLANTIC) LTD.
2012-02-06	66799	LIFE TECHNOLOGIES INC. TECHNOLOGIES LIFE INC.	From:	66824	SAFETY INSURANCE SERVICES (ATLANTIC) LTD.

		MINERAL ACT	
2012-02-10	66837	SAFETY INSURANCE SERVICES (ATLANTIC) LTD.	
From:	66833	SAFETY INSURANCE SERVICES (ATLANTIC) LTD.	NOTICE
2012-02-13	66845	GENERAL MOTORS FINANCIAL OF CANADA, LTD./FINANCIERE GENERAL MOTORS DU CANADA LTEE	Published in accordance with section 62 of CNLR 1143/96 under the <i>Mineral Act</i> , RSNL1990, cM-12, as amended.
From:	5755F	GENERAL MOTORS FINANCIAL OF CANADA, LTD./FINANCIERE GENERAL MOTORS DU CANADA LTEE	Mineral rights to the following mineral licenses have reverted to the Crown:
			Mineral License 000785M Held by CanAlaska Uranium Ltd. Situate near Makhavinekh Mountain On map sheet 14D/01 14D/08
2012-02-17	66893	ALTERA CANADA CO.	
From:	60702	ALTERA NEWFOUNDLAND TECHNOLOGY CORP.	Mineral License 006469M Held by Murphy, Lewis Situate near Great Gull Pond, Central NL On map sheet 12H/01
2012-02-20	66906	CONNOR, CLARK & LUNN INVESTMENT MANAGEMENT LTD.	
From:	53210	CONNOR, CLARK & LUNN INVESTMENT MANAGEMENT LTD.	Mineral License 010756M Held by Corner Brook Pulp and Paper Limited Situate near Middle Brook, Western NL On map sheet 12B/07
2012-02-20	66910	RECKITT BENCKISER (CANADA) INC.	
From:	3397D	RECKITT BENCKISER (CANADA) INC.	Mineral License 010755M Held by Corner Brook Pulp and Paper Limited Situate near Rattling Brook, Western NL On map sheet 12B/07
2012-02-21	66915	VALEANT PHARMACEUTICALS INTERNATIONAL, INC.	
From:	54514	VALEANT PHARMACEUTICALS INTERNATIONAL, INC.	A portion of license 017871M Held by Paragon Minerals Corporation Situate near Winter Hill, Southern NL On map sheet 01M/12
2012-02-24	66948	GL NOBLE DENTON CANADA LIMITED	more particularly described in an application on file at Department of Natural Resources
From:	64363	GL NOBLE DENTON CANADA LIMITED	A portion of license 016240M Held by Capella Resources Ltd. Situate near Wilson Lake On map sheet 13E/07
2012-02-28	66971	MMM GROUP LIMITED	more particularly described in an application on file at Department of Natural Resources
From:	62196	MCCORMICK RANKIN CORPORATION	
	60061	MMM GROUP LIMITED	
2012-02-28	66974	PRIMUS TELECOMMUNICATIONS CANADA INC.	
From:	53260	PRIMUS TELECOMMUNICATIONS CANADA INC.	A portion of license 017756M Held by Capella Resources Ltd. Situate near Wilson Lake On map sheet 13E/09 more particularly described in an application on file at Department of Natural Resources
Total Registrations for Amalgamation: 25			Mineral License 013117M Held by Courtney, Stephen Situate near Island Pond, Central NL On map sheet 02D/13
		SERVICE NL Registrar of Companies Dean Doyle, Registrar	
Apr 20			Mineral License 013119M Held by Golden Dory Resources Corp. Situate near St. Lawrence Area, Burin Peninsula On map sheet 01L/14
			Mineral License 013120M Held by Ryan, Kevin Situate near Burnt Woods Pond, Burin Peninsula On map sheet 01M/03

THE NEWFOUNDLAND AND LABRADOR GAZETTE
April 20, 2012

Mineral License Held by Situate near On map sheet	013121M Ryan, Kevin Lunch Pond, Burin Peninsula 01M/03	Situate near On map sheet more particularly described in an application on file at Department of Natural Resources	Wilson Lake 13E/07
Mineral License Held by Situate near On map sheet	013129M Mega Uranium Ltd. Lake Michael 13J/09 13J/10	A portion of license Held by Situate near On map sheet more particularly described in an application on file at Department of Natural Resources	017450M 017451M Capella Resources Ltd. Wilson Lake 13E/09
Mineral License Held by Situate near On map sheet	017405M Quinlan, Eddie Kaipokok Bay 13J/13	Mineral License Held by Situate near On map sheet	015643M Benton Resources Corp. Iglusuataliksuak Lake 14D/16 14E/01
Mineral License Held by Situate near On map sheet	017403M Quinlan, Eddie Kaipokok Bay 13J/13	Mineral License Held by Situate near On map sheet	015651M 1512513 Alberta Ltd. Main River Area, Western NL 12H/15 12H/14
Mineral License Held by Situate near On map sheet	017406M Quinlan, Eddie Kaipokok Bay 13J/13	Mineral License Held by Situate near On map sheet	016595M Midland Exploration Inc. Lac Chaves 13L/13
Mineral License Held by Situate near On map sheet	017404M Quinlan, Eddie Kaipokok Bay 13J/13	Mineral License Held by Situate near On map sheet	016609M Midland Exploration Inc. Lac Chaves 13L/13
Mineral License Held by Situate near On map sheet	017407M Quinlan, Eddie Kaipokok Bay 13J/13	Mineral License Held by Situate near On map sheet	016623M Penney, Brian Isabella Falls 13L/02
Mineral License Held by Situate near On map sheet	017467M Hicks, Darrin Terra Nova North River, Eastern NL 02D/07	Mineral License Held by Situate near On map sheet	016657M Penney, Brian Isabella Falls 13L/02
Mineral License Held by Situate near On map sheet	013170M Alterra Resources Inc. Change Islands, Central NL 02E/09	Mineral License Held by Situate near On map sheet	016889M Atlantic Antimony Ltd. Northwest Gander River, Central NL 02D/11
Mineral License Held by Situate near On map sheet	017521M Wolverine Exploration Inc. Hamilton River 13F/04	Mineral License Held by Situate near On map sheet	016893M Atlantic Antimony Ltd. Northwest Gander River, Central NL 02D/11
Mineral License Held by Situate near On map sheet	014401M Clarke, Franklin F. Northern Harbour, Western NL 12A/13	Mineral License Held by Situate near On map sheet	016909M KAT Gold Holdings Corp. Blackhead Bay, Eastern NL 02C/11
Mineral License Held by Situate near On map sheet	017445M Capella Resources Ltd. Seal Lake 13K/06	Mineral License Held by Situate near On map sheet	016989M Atlantic Antimony Ltd. Northwest Gander River, Central NL 02D/11
A portion of license Held by Situate near On map sheet more particularly described in an application on file at Department of Natural Resources	017448M Capella Resources Ltd. Wilson Lake 13E/07	Mineral License Held by Situate near On map sheet	016997M Critchley, Hayward Dead Wolf Brook, Central NL 02D/10
A portion of license Held by	017449M Capella Resources Ltd.	Mineral License Held by	017003M Vale Exploration Canada Inc.

THE NEWFOUNDLAND AND LABRADOR GAZETTE
April 20, 2012

Situate near On map sheet	Tickle Cove, Eastern NL 02C/11 02C/12	Situate near On map sheet	Lake Michael Area 13J/09
Mineral License Held by Situate near On map sheet	017004M Vale Exploration Canada Inc. Blackhead Bay, Eastern NL 02C/06 02C/11	Mineral License Held by Situate near On map sheet	018287M Ramji, Shainul Deer Lake Area, Western NL 12H/04
Mineral License Held by Situate near On map sheet	017052M Atlantic Antimony Ltd. Northwest Gander River, Central NL 02D/11	Mineral License Held by Situate near On map sheet	018288M Ramji, Shainul Deer Lake Area, Western NL 12H/04
Mineral License Held by Situate near On map sheet	017835M Martin, Cameron Crooks Lake 13B/11	Mineral License Held by Situate near On map sheet	018298M Ramji, Shainul Deer Lake Area, Western NL 12H/03
Mineral License Held by Situate near On map sheet	019951M Midland Exploration Inc. Lac Chapiteau Area 13M/06 13M/11	Mineral License Held by Situate near On map sheet	018315M LeDrew, Donald Rocky Pond, Central NL 02E/02
Mineral License Held by Situate near On map sheet	019952M Midland Exploration Inc. Lac Chapiteau Area 13M/11	Mineral License Held by Situate near On map sheet	018316M LeDrew, Donald Rocky Pond, Central NL 02E/02
Mineral License Held by Situate near On map sheet	018020M Unity Resources Inc. Rolling Pond, Central NL 02D/12	Mineral License Held by Situate near On map sheet	018317M LeDrew, Donald Jonathans Pond Area, Central NL 02E/02
Mineral License Held by Situate near On map sheet	018225M Noel, E. Michele Indian Arm Pond Area, Central NL 02E/03	Mineral License Held by Situate near On map sheet	018319M Denty, Paul Culls Harbour, Eastern NL 02C/12
Mineral License Held by Situate near On map sheet	018264M Ramji, Shainul Deer Lake Area, Western NL 12H/03 12H/04	Mineral License Held by Situate near On map sheet	018320M Denty, Paul Culls Harbour, Eastern NL 02C/12
Mineral License Held by Situate near On map sheet	018265M Messina Minerals Inc. York Harbour, Western NL 12G/01	Mineral License Held by Situate near On map sheet	018388M Courtney, Stephen Exploits River, Central NL 02D/13
Mineral License Held by Situate near On map sheet	018266M Messina Minerals Inc. York Harbour Area, Western NL 12B/16 12G/01	Mineral License Held by Situate near On map sheet	018392M Knight, Kenneth Georges Lake, Western NL 12B/16
Mineral License Held by Situate near On map sheet	018267M Messina Minerals Inc. York Harbour, Western NL 12G/01	Mineral License Held by Situate near On map sheet	018393M Knight, Kenneth Georges Lake, Western NL 12B/16
Mineral License Held by Situate near On map sheet	018278M Sweetapple, Ronald Duder Lake Area, Central NL 02E/07	Mineral License Held by Situate near On map sheet	018394M Knight, Kenneth Serpentine Lake Area, Western NL 12B/16
Mineral License Held by Situate near On map sheet	018279M Sweetapple, Walter Duder Lake Area, Central NL 02E/07	A portion of license Held by Situate near On map sheet	018627M Zonte Metals Inc. Bellmans Pond, Central NL 02E/02 02E/07
Mineral License Held by	018282M Unity Resources Inc.	more particularly described in an application on file at Department of Natural Resources	

The lands covered by this notice except for the lands within Exempt Mineral Lands, the Exempt Mineral Lands being described in CNLR 1143/96 and NLR 71/98, 104/98, 97/00, 36/01, 31/04, 78/06, 8/08 and 28/09 and outlined on 1:50 000 scale digital maps maintained by the Department of Natural Resources, will be open for staking after the hour of 9:00 a.m. on the 32nd clear day after the date of this publication.

DEPARTMENT OF NATURAL RESOURCES
JIM HINCHEY, P.Geo
Manager - Mineral Rights

File #s 774: 0448, 3328, 5061, 6825, 7038, 7041, 7974,
7976, 7977, 7978, 7984, 7987, 7988, 7989,
7990, 7991, 7992, 8023, 8025, 8041, 9181,
9206, 9347, 9349, 9350, 9351;
775: 0010, 0018, 0463, 0477, 0491, 0510, 0656,
0657, 0664, 0710, 0713, 0719, 0720, 0730,
1251, 1401, 1409, 1592, 1627, 1628, 1629,
1630, 1641, 1642, 1645, 1650, 1651, 1657,
1674, 1675, 1676, 1678, 1679, 1744, 1748,
1749, 1750, 1752, 1963

Apr 20

CITY OF ST. JOHN'S



**ST. JOHN'S MUNICIPAL COUNCIL
NOTICE
ST. JOHN'S TICKETING AMENDMENT BY-LAW**

TAKE NOTICE that the ST. JOHN'S MUNICIPAL COUNCIL has enacted an amendment to the St. John's Ticketing (Amendment No. 2 – 2012) By-Law.

The said Amendment was passed by Council on the 9th day of April, 2012, so as to update provisions related to "disabled parking spaces" to reference "mobility impaired parking spaces".

All persons are hereby required to take notice that any person who wishes to view such Regulations may view same at the Office of the City Solicitor of the ST. JOHN'S MUNICIPAL COUNCIL at City Hall, and that any person who wishes to obtain a copy thereof may obtain it at the said office upon the payment of a reasonable charge as established by the ST. JOHN'S MUNICIPAL COUNCIL for such copy.

Dated this 11th day of April, 2012.

CITY OF ST. JOHN'S
Neil Martin - City Clerk

Apr 20

URBAN AND RURAL PLANNING ACT

**NOTICE OF REGISTRATION
TOWN OF LABRADOR CITY
DEVELOPMENT REGULATIONS
AMENDMENT No. 12, 2011**

TAKE NOTICE that the TOWN OF LABRADOR CITY Development Regulations Amendment No. 12, 2011, adopted by Council on the 27th day of March, 2012, has been registered by the Minister of Municipal Affairs.

In general terms, Development Regulations Amendment No. 12, 2011, will re-define the definition for Workers Residence (temporary) to Temporary Workers Residence (Housing), Schedule A. The amendment will list Temporary Workers Residence (Housing) as a discretionary use for the commercial residential use class of the Commercial Highway (CH); Mixed Development (MD); Commercial General (CG); Central Business District (CBD); Light Industry (LI); and General Industrial (GI) Land Use Zone Tables, and further define the Condition for Temporary Worker's Housing, to provide Council with further discretion. A condition for "Commercial Residential (Temporary Worker's Housing only) as a Discretionary Use, is added to the Mineral Extraction (ME) and Mining Reserve Rural (MRR) Land Use Zone Tables, and the condition for Temporary Workers Residence (Housing), exclusively limited to the development of residential units as a discretionary use, as found in the Residential-1 (R-1) and Residential-2 (R-2) Land Use Zone Tables, Schedule C, is also amended.

The TOWN OF LABRADOR CITY Development Regulations Amendment No. 12, 2011, comes into effect on the day that this notice is published in *The Newfoundland and Labrador Gazette*. Anyone who wishes to inspect a copy of the TOWN OF LABRADOR CITY Development Regulations Amendment No. 12, 2011, may do so at the Town Office, Labrador City during normal working hours.

TOWN OF LABRADOR CITY
Diane Gear, Town Clerk

Apr 20

**NOTICE OF REGISTRATION
TOWN OF MARYSTOWN
MUNICIPAL PLAN
AMENDMENT NO. 19, 2011
AND
DEVELOPMENT REGULATIONS
AMENDMENT NO. 27, 2011**

TAKE NOTICE that the TOWN OF MARYSTOWN Municipal Plan Amendment No. 19, 2011 and Development Regulations Amendment No. 27, 2011 as adopted on the 7th day of February, 2012 and approved on the 20th day of March, 2012, have been registered by the Minister of Municipal Affairs.

The purpose of the amendments is to accommodate a dwelling off Pidgeon's Road by redesignating and rezoning a parcel of land from Rural to Residential.

The Municipal Plan Amendment No. 19, 2011 and Development Regulations Amendment No. 27, 2011 come into effect on the day that this notice is published in *The Newfoundland and Labrador Gazette*.

Anyone who wishes to inspect a copy of the Marystown Municipal Plan Amendment No. 19, 2011 and Development Regulations Amendment No. 27, 2011 may do so at the Marystown Town Office during normal working hours.

TOWN OF MARYSTOWN
Dennis Kelly, Town Clerk/Manager

Apr 20

**NOTICE OF REGISTRATION
TOWN OF NORTH WEST RIVER
MUNICIPAL PLAN
AND DEVELOPMENT REGULATIONS**

TAKE NOTICE that the TOWN OF NORTH WEST RIVER Municipal Plan and Development Regulations, adopted on the 11th day of October, 2011, has been registered by the Minister of Municipal Affairs.

The Municipal Plan and Development Regulations come into effect on the day that this notice is published in *The Newfoundland and Labrador Gazette*. Anyone who wishes to inspect a copy of them may do so at the Town Office, 100 Mission Rd. during normal working hours.

TOWN OF NORTH WEST RIVER
Wendy Hillier, Town Clerk

Apr 20

**NOTICE OF REGISTRATION
TOWN OF STEPHENVILLE CROSSING
MUNICIPAL PLAN AMENDMENT NO. 1, 2011
DEVELOPMENT REGULATIONS
AMENDMENT NO. 1, 2011**

TAKE NOTICE that the TOWN OF STEPHENVILLE CROSSING Municipal Plan Amendment No. 1, 2011 and Development Regulations Amendment No. 1, 2011 as adopted on the 15th day of February, 2012 and approved on the 21st day of March 2012 have been registered by the Minister of Municipal Affairs.

The general purpose of the amendments is to accommodate seasonal residential development within the Rural

designation and zone on a discretionary basis, subject to certain conditions which restrict such development to approved cottage development areas as defined by the Department of Environment and Conservation or established cottage areas within the Planning Area.

Furthermore, the Development Regulations Regulation 87 (1) is amended to enable the Town to require a higher standard of road construction or services construction than provided for under the standard provincial government specifications. This amendment only pertains to the Development Regulations.

The Municipal Plan Amendment No. 1, 2011 and Development Regulations Amendment No. 1, 2011 come into effect on the day that this notice is published in *The Newfoundland and Labrador Gazette*.

Anyone who wishes to inspect a copy of the Stephenville Crossing Municipal Plan Amendment No. 1, 2011 and Development Regulations Amendment No. 1, 2011 may do so at the Stephenville Crossing Town Office during normal working hours.

TOWN OF STEPHENVILLE CROSSING
Yvonne Young, Town Clerk/Manager

Apr 20

**LANDS ACT
NOTICE OF INTENT
*Lands Act, c36, SNL 1991, as amended***

NOTICE IS HEREBY given that the TOWN OF CHAPEL ARM, NL, intends to apply to the Department of Environment and Conservation, two months from the publication of this notice, to acquire title, pursuant to section 7(2) of the said Act, to that piece of Crown Land situated within fifteen (15) meters of the waters of Chapel Arm in the Electoral District of Bellevue for the purpose of Recreation Facilities. The land is described as follows:

*Bounded on the North by Residence
Bounded on the East by Ocean
Bounded on the South by Town's Property
Bounded on the West by Main Street
and containing an area of
approximately 2030 square meters*

Any person wishing to object to the application must file the objection, in writing, within one month from the publication of this Notice, with reasons for it, to the Minister of Environment and Conservation, and mail to the nearest Regional Lands Office:

c/o Eastern Regional Lands Office, P.O. Box 8700, 5 Mews Place, St. John's, NL, A1B 4J6.

c/o Central Regional Lands Office, P.O. Box 2222, Gander, NL, A1V 1L7.

c/o Western Regional Lands Office, P.O. Box 2006, Noton Building, Corner Brook, NL, A2H 6J8.

c/o Labrador Regional Lands Office, P.O. Box 3014,
Station "B", Happy Valley-Goose Bay, NL, A0P 1E0

For further information on the proposed application, please
contact the TOWN OFFICE, CHAPEL ARM, telephone
number (709) 592-2720.

Apr 20

MECHANICS' LIEN ACT

**NOTICE OF INTENTION TO RELEASE
MECHANICS' LIEN HOLDBACK
PURSUANT TO SECTION 12 OF THE
MECHANICS' LIEN ACT
RSNL 1990, cM-3 (THE "ACT")**

PURSUANT TO section 12 of the Act, and in relation to a
contract A4VI-30-CA0004 entered into between Vale
Newfoundland and Labrador Limited and BMA
Constructors which contract is dated as of August 11th,
2010, notice is hereby given of the intention of Vale
Newfoundland and Labrador Limited, to the release of
mechanics' lien holdback funds 30 days following the date
of this notice.

Dated at St. John's, NL, this 13th day of April 2012.

FLUOR CANADA LIMITED
Troy Gilson, Project Contracts Manager
(acting as Agent for Vale NL Limited)

Apr 20, 27, May 4 & 11

**NOTICE OF INTENTION TO RELEASE
MECHANICS' LIEN HOLDBACK
PURSUANT TO SECTION 12 OF THE
MECHANICS' LIEN ACT
RSNL 1990, cM-3 (THE "ACT")**

PURSUANT TO section 12 of the Act, and in relation to a
contract A4VI-90-CG0052 entered into between Vale
Newfoundland and Labrador Limited and Compass Group
Canada Limited which contract is dated as of March 5,
2010, notice is hereby given of the intention of Vale
Newfoundland and Labrador Limited, to the release of
mechanics' lien holdback funds 30 days following the date
of this notice.

Dated at St. John's, NL, this 12th day of April 2012.

FLUOR CANADA LIMITED
Troy Gilson, Project Contracts Manager
(acting as Agent for Vale NL Limited)

Apr 20, 27, May 4 & 11

QUIETING OF TITLES ACT

**2012 01G. No. 0984
IN THE SUPREME COURT OF
NEWFOUNDLAND AND LABRADOR
TRIAL DIVISION (GENERAL)**

IN THE MATTER of an Application of ALBERT
CHRISTOPHER, pursuant to the *Quieting of Titles Act*,
RSNL 1990, cQ-3

AND

IN THE MATTER of that piece or parcel of land situate at
Bay Roberts, in the Province of Newfoundland and
Labrador (hereinafter referred to as the "Subject Property")

NOTICE OF APPLICATION under the *Quieting of Titles
Act*, RSNL 1990, cQ-3, as amended;

Notice is hereby given to all parties that ALBERT
CHRISTOPHER applied to the Supreme Court of
Newfoundland and Labrador, St. John's, to have the title to
ALL THAT piece or parcel of land situate in the Town of
Bay Roberts, in the Province of Newfoundland and
Labrador and being more particularly described in
Schedule "A" hereto annexed and outlined on the plan
annexed hereto marked Schedule "B" for which he claims
to be the owner, investigated and for a Declaration that he
is the absolute owner in fee simple and that he has been
ordered to publish notice of the Application as required by
the before-noted Act.

All persons having title adverse to the said title claimed by
ALBERT CHRISTOPHER shall file in the Registry of the
Supreme Court of Newfoundland and Labrador, St. John's,
in the Province of Newfoundland and Labrador, particulars
of such adverse claim and serve the same together with an
Affidavit verifying same on the undersigned Solicitor for
the Applicant on or before the 30th day of April, 2012 after
which date no party having any claim shall be permitted to
file the same or to be heard except by special leave of the
Court and subject to such conditions as the Court may
deem just.

All such adverse claims shall then be investigated in such
manner as the said Supreme Court of Newfoundland and
Labrador, St. John's, may direct.

DATED at Bay Roberts, in the Province of Newfoundland
and Labrador, this 26th day of March, 2012.

MORROW & MORROW
Solicitor for the Applicant
PER: Adam S. Gosse

ADDRESS FOR SERVICE:
P.O. Box 870
Bay Roberts, NL

Tel: (709) 786-9207
Fax: (709) 786-9507

SCHEDULE "A"

All that piece or parcel of land situate, and being on the northwestern side of the Waters of Bay Roberts and to the southeast of Mercer's Cove Road, in the Town of Bay Roberts, in the Electoral District of Port de Grave, in the Province of Newfoundland and Labrador, and being bound and abutted as follows:

BEGINNING at a point, to the Southeast of Mercer's Cove Road, said point being the Northwestern corner of the herein described land and having NAD 83 coordinates of North 5 273543.456 meters and East 287 865.645 meters on the Modified Three Degree Transverse Mercator Projection for the province of Newfoundland and Labrador, (Zone 1):

THENCE running land of Albert Menchions and the Southeastern end of a Right-of-Way (3.5m Wide) North 42° 01' 25" East 12.659 meters;

THENCE running land of Albert Menchions South 44° 33' 57" East 13.779 meters; South 42° 42' 08" East 6.810 meters;

THENCE running by a filled Area Claimed by Albert Thomas Christopher and Albert Menchions South 25° 09' 47" East 0.731 meters; South 49° 16' 11" East 4.384 meters;

THENCE running by the Waters of Bay Roberts South 41° 04' 40" West 10.637 meters;

THENCE running by land of Frank Mercer North 48° 30' 28" West 16.199 meters; North 46° 53' 07" West 9.110 meters, more or less, to the Point of Beginning

The above described piece or parcel of land contains an area of 298 Square Meters, more or less. Which land is as shown and delineated on the attached plan dated August 14, 2008.

All bearings being referred to Grid North.

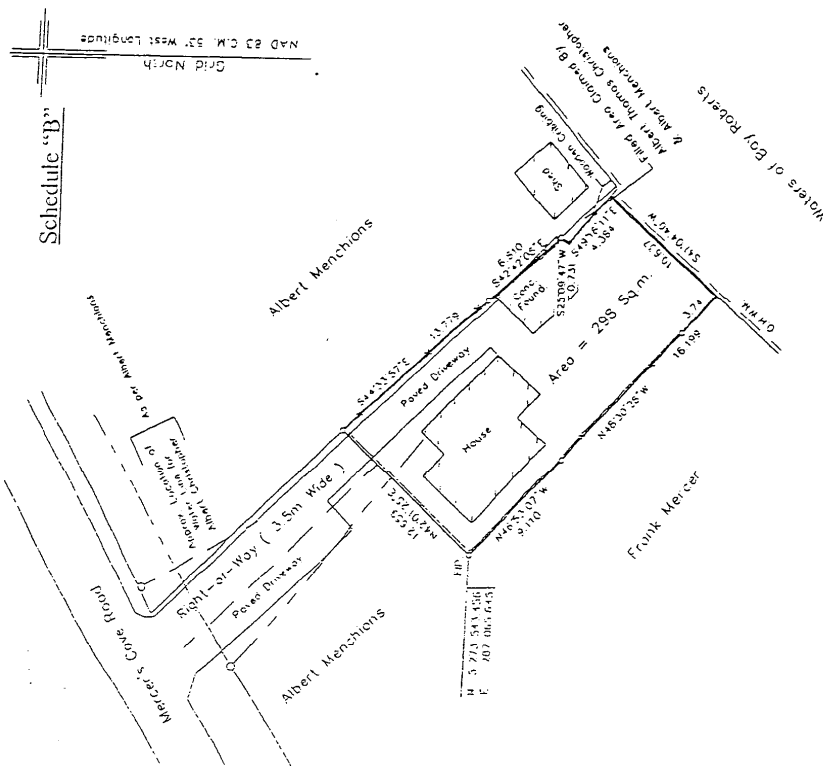

NOTE:
 (a) Unauthorized use, alteration or reproduction is prohibited by law as outlined in THE COPYRIGHT ACT. However, use and reproduction thereof by or on behalf of the person to whom this report is entitled is permitted, provided that no alterations whatsoever are made thereunder.

Capital Monument Values:
 BIG2176 N 5 273 310.616
 C 206 703.747
 BIG2178 N 5 274 550.177
 E 207 899.326

Fence:
 Power Line:
 Capped Iron Pin:
 Found Iron Pin:
 Fence Post:
 Scale Factor: 0.999898

NORMAN & PARSONS SURVEYS LIMITED,
 Newfoundland Land Surveyors
 P.O. Box 697 Bay Roberts NL A0A 1C0

SURVEY ON BEHALF OF
 Albert Thomas Christopher

Mercer's Cove, Bay Roberts
 Scale: 1:300
 Date: Aug. 14, 2008
 Survey by: NL
 Plan No. UN 2008029

TRUSTEE ACT

ESTATE NOTICE

IN THE ESTATE OF SHARON COLLINS, of the City of Mount Pearl, in the Province of Newfoundland and Labrador, Retail Manager, Deceased.

All persons claiming to be creditors of or who have any claims or demands upon or affecting the estate of SHARON COLLINS, of the City of Mount Pearl, in the Province of Newfoundland and Labrador, Retail Manager, Deceased, are hereby requested to send particulars thereof in writing, duly attested, to the undersigned Solicitors for the Administratrix of the said Deceased, on or before the 31st day of May, 2012 after which date the Administratrix will proceed to distribute the said Estate having regard only to the claims of which they then shall have had notice.

DATED at St. John's, this 27th day of March, 2012.

 BENSON BUFFETT PLC INC.
 Barristers and Solicitors
 PER: Jude W. Hall

ADDRESS FOR SERVICE:
Suite 900, Atlantic Place
215 Water Street
P. O. Box 1538
St. John's, NL A1C 5N8

Tel: 709-579-2081
Fax: 709-579-2647

Apr 13 & 20

ESTATE NOTICE

IN THE ESTATE OF LUCY BERNADETTE MCCARTHY, of the Town of Paradise, in the Province of Newfoundland and Labrador, Housewife, Deceased.

All persons claiming to be creditors of or who have any claims or demands upon or affecting the estate of LUCY BERNADETTE MCCARTHY, of the Town of Paradise, in the Province of Newfoundland and Labrador, Housewife, Deceased, are hereby requested to send particulars thereof in writing, duly attested, to the undersigned Solicitors for the Executor of the said Deceased, on or before the 31st day of May, 2012 after which date the Executor will proceed to distribute the said Estate having regard only to the claims of which they then shall have had notice.

DATED at St. John's, this 27th day of March, 2012.

 BENSON BUFFETT PLC INC.
 Barristers and Solicitors
 PER: Jude W. Hall

ADDRESS FOR SERVICE:
Suite 900, Atlantic Place
215 Water Street
P. O. Box 1538
St. John's, NL A1C 5N8

Tel: 709-579-2081
Fax: 709-579-2647

Apr 13 & 20

ESTATE NOTICE

IN THE MATTER of the Estate of VINCENT HYNES, late of St. John's, in the Province of Newfoundland and Labrador, Deceased,

All persons claiming to be creditors of or who have any claims or demands either as beneficiaries or next of kin (by blood, legal adoption or marriage) upon or affecting the Estate of VINCENT HYNES, Gentleman, who died at St. John's, NL on or about January 4th, 1998, are hereby requested to send particulars thereof in writing, duly attested, to the Office of the Public Trustee, 401 - 136 Crosbie Road, St. John's, NL, A1B 3K3, Administrator of the Estate of VINCENT HYNES, on or before May 23rd, 2012, after which date the said Administrator will proceed to distribute the Estate having regard only to the claims of which he then shall have had notice.

DATED at St. John's, this 10th day of April, 2012

 OFFICE OF THE PUBLIC TRUSTEE
 Administrator of the Estate of Vincent Hynes

ADDRESS FOR SERVICE
Office of the Public Trustee,
401 - 136 Crosbie Road,
St. John's, NL, A1B 3K3

Tel: 709-729-1025
Fax: 709-729-3063

Apr 20



THE NEWFOUNDLAND AND LABRADOR GAZETTE

PART II

SUBORDINATE LEGISLATION FILED UNDER THE STATUTES AND SUBORDINATE LEGISLATION ACT

Vol. 87

ST. JOHN'S, FRIDAY, APRIL 20, 2012

No. 16

NEWFOUNDLAND AND LABRADOR REGULATIONS

NLR 28/12
NLR 29/12



**NEWFOUNDLAND AND LABRADOR
REGULATION 28/12**

*Notice of Protected Water Supply Area
of Gorges Pond, WS-S-0881
under the
Water Resources Act*

(Filed April 17, 2012)

Under the authority of section 39 of the *Water Resources Act*, I designate the area generally known as the *Gorges Pond Water Supply Area, WS-S-0881*, for the Town of Humber Arm South as a protected water supply area.

Dated at St. John's, April 12, 2012.

Terry French
Minister of Environment and Conservation

NOTICE

This area includes all lands in the Provincial Electoral District of Trinity North abutted and bounded as follows:

Beginning at a point having scaled UTM coordinates of easting 414,447 metres and northing 5,432,209 metres;

Then running in a southeasterly direction for a distance of 223 metres, more or less, to a point having scaled UTM coordinates of easting 414,632 metres and northing 5,432,084 metres;

Then running in a southerly direction for a distance of 134 metres, more or less, to a point having scaled UTM coordinates of easting 414,623 metres and northing 5,431,951 metres;

Then running in a southeasterly direction for a distance of 243 metres, more or less, to a point having scaled UTM coordinates of easting 414,805 metres and northing 5,431,789 metres;

Then running in a southerly direction for a distance of 557 metres, more or less, to a point having scaled UTM coordinates of easting 414,723 metres and northing 5,431,239 metres;

Then running in a westerly direction for a distance of 153 metres, more or less, to a point having scaled UTM coordinates of easting 414,578 metres and northing 5,431,187 metres;

Then running in a northeasterly direction for a distance of 158 metres, more or less, to the point of commencement.

All coordinates refer Zone 21N of the NAD 83 Universal Transverse Mercator Projection.

©William E. Parsons, Queen's Printer



**NEWFOUNDLAND AND LABRADOR
REGULATION 29/12**

*Repeal of Notice of Protected Watershed Area
of South Pond
under the
Water Resources Act*

(Filed April 17, 2012)

Under the authority of section 39 of the *Water Resources Act*, I give the following notice.

Dated at St. John's, April 12, 2012.

Terry French
Minister of Environment and Conservation

NOTICE

The *Notice of Protected Watershed Area of South Pond, Consolidated Newfoundland and Labrador Regulation 701/96*, is repealed.

©William E. Parsons, Queen's Printer

Index

PART I

Canada-Newfoundland Atlantic Accord Implementation Act And Canada-Newfoundland and Labrador Atlantic Accord Implementation Newfoundland And Labrador Act– Notice	159
City of St. John’s Act – Notice	171
Corporations Act – Notices	162
Lands Act – Notice	172
Mechanics’ Lien Act – Notices.....	173
Mineral Act – Notice	168
Quieting of Titles Act – Notice	173
Urban and Rural Planning Act, 2009 – Notices	171
Trustee Act – Notices	175

PART II

CONTINUING INDEX OF SUBORDINATE LEGISLATION

Title of Act and Subordinate Legislation made thereunder	CNLR or NL Reg.	Amendment	NL Gazette Date & Page No.
Water Resources Act			
Notice of Protected Water Supply Area of Gurges Pond, WS-S-0881	NLR 28/12	New	Apr 20/12 p. 519
Repeal of Notice of Protected Watershed Area of South Pond	NLR 29/12	Repeals CNLR 701/96	Apr 20/12 p. 521

The Newfoundland and Labrador Gazette is published from the office of William E. Parsons, Queen's Printer.

Copy for publication must be received by **Friday, 4:30 p.m.**, seven days before publication date to ensure inclusion in next issue.

Advertisements must be submitted in either PDF format or as a MSWord file. When this is not possible, advertisements must be either typewritten or printed legibly, separate from covering letter. Number of insertions required must be stated and the names of all signing officers typewritten or printed.

Copy may be mailed to the address below, faxed to (709) 729-1900 or emailed to queensprinter@gov.nl.ca.

Advertising rates are available upon request. Subscription rate for *The Newfoundland and Labrador Gazette* is \$125.00 for 52 weeks plus applicable tax (\$131.25). Weekly issues of \$3.00 per copy, plus tax payable in advance.

All cheques, money orders, etc., should be made payable to THE NEWFOUNDLAND EXCHEQUER ACCOUNT and all correspondence should be addressed to: Office of the Queen's Printer, P. O. Box 8700, Ground Floor, East Block, Confederation Building, St. John's, NL A1B 4J6. Telephone (709) 729-3649. Fax: (709) 729-1900.

Web Site: <http://www.gs.gov.nl.ca/printer/index.html>

**Place your order by contacting:
Office of The Queen's Printer
Confederation Building, East Block
St. John's, NL A1B 4J6
Telephone: (709) 729-3649 Fax: (709) 729-1900
email: queensprinter@gov.nl.ca**

**Government Information Product
Publication Rate Mail**

G.S.T. # R107442683

All requests for Subscription and Legislation MUST be prepaid.